

All specifications and figures are subject to change without notice for improvement.



<https://forklift-manuals.jimdofree.com>

Ningbo Ruyi Joint Stock Co., Ltd

Sales Headquarter:
North 3/F, West Lake Ming Building, 298 Qingchun Road,
Hangzhou, Zhejiang 310006, P.R. China

Tel : 86-571-87153626 87153634
Fax: 86-571-87153628 87153638

www.XILIN.com

sales@xilin.com / ruyi@xilin.com

Factory Address:
656 North Taoyuan Road, Ninghai, Zhejiang 315600, P.R. China

Scan For Details



2014 SPRING

如意

NINGBO RUYI
JOINT STOCK CO.,LTD

xilin®

Since 1985
29 Years



“ It is a real delight to have friends with similar ideals coming from afar.”

—— Confucius
(B.C 551-B.C 479)
The great philosopher and educationalist in ancient China

<https://forklift-manuals.jimdofree.com>



NINGBO RUYI JOINT STOCK CO.,LTD

COMPANY INTRODUCTION →



<https://forklift-manuals.jimdofree.com>

NINGBO RUYI was established in 1985.

We have 1500 employees totally, 188 professional mechanical technicians , 77 senior engineers and 120 sales people. Our factory covers an area of 150,000 square meters, green area is around 30000 square meter.

Our products line are more than 430 type warehouse equipments such as Manual/Electric Pallet Truck, Manual/Electric Stacker, Reach Truck, Order pickers , Lift Table Trucks, Tractors and Forklift, with capacity from 500kgs to 5000kgs . Our market covers more than 145 countries and regions all over the world.

ISO International certificate from CQC :

Early in 1995, NINGBO RUYI got the international certificate of ISO9002.

NINGBO RUYI got the international certificate of :

- **ISO9001: 2008** (Design, develop, Manufacture and service)
- **ISO14001:2004** (Environmental Management System)
- **OHSAS18001:1999** (Occupational Health and Safety Management system)。

CE/GS/TUV Certificate :

Early in 1991 , NINGBO RUYI passed TUV safety inspection and get the GS certificate for Hand Pallet Trucks . As a matter of fact , Ningbo Ruyi was **FIRST** manufacturer and exporter in China who got the TUV/GS/CE certificate for products of Hand Pallet Trucks .

In 2012 NINGBO RUYI passed **The National Exemption From Export Inspection** from The General Administration of Quality Supervision , inspection and Quarantine of the P.R.C.

Award and reputation

- China Top Brand
- China Famous brand
- The AAA class credit Award enterprise
- Tax credit of A grade award
- The Enterprise technology center of Zhejiang
- The first-class export management award
- The leading enterprise of the metal mechanical industry award
- Zhejiang Province level civilized units award
- The credit enterprise award
- Ningbo High and New Tech Enterprises Award
- NO 1 Science and Technology Awards
- China charity Certificate
- The Green Enterprise of Zhejiang province

Technical achievement

- Different products have got 35 national patents, among which have:
 - 2 Invention patent
 - 11 Utility Model Patents
 - 12 Appearance patents
- NINGBO RUYI participated drafting three Chinese national standards' revision related to Manual Pallet Trucks and Electric Trucks .

RUYI means "everything is the best and being happy " . We are always trying our best to make you satisfied with everything you purchased from us.



PRODUCT INDEX

08-24

Series Pallet Truck



25-45

Electric Pallet Truck



46-57

Electric Tow Tractor



58-60

Manual Stacker



<https://forklift-manuals.jimdofree.com>

61-91

Electric Stacker



92-105

Narrow Aisle Truck



106-111

Manual & Power Lift Table



Series Pallet Truck



Hand Pallet Truck



Model: BF

1KG=2.205LB 1INCH=25.40MM

| Model | | BF | |
|---|---------------|----------------|----------------|
| Capacity | Q(kg) | 2500/3000 | 2500/3000 |
| Lowered fork height | h_{10} (mm) | 85 | 75 |
| Steering wheel | mm | ϕ 200 | ϕ 180 |
| Fork wheel single | mm | ϕ 80x93 | ϕ 74x93 |
| Fork wheel tandem | mm | ϕ 80x70 | ϕ 74x70 |
| Max. lift height | h_2 (mm) | 200 | 190 |
| Total height | h_{14} (mm) | 1224 | 1214 |
| Overall length | l_1 (mm) | 1483/1533/1603 | 1483/1533/1603 |
| Fork length | l (mm) | 1100/1150/1220 | 1100/1150/1220 |
| Width overall forks | b_5 (mm) | 520/550/685 | 520/550/685 |
| Ground clearance, centre of wheelbase | m_2 (mm) | 32 | 22 |
| Aisle width for pallets 1000x1200 crossways | A_x (mm) | 1683/1733/1803 | 1683/1733/1803 |
| Aisle width for pallets 800x1200 lengthways | A_x (mm) | 1783/1783/1803 | 1783/1783/1803 |
| Turning radius | W_s (mm) | 1216/1266/1336 | 1216/1266/1336 |
| Service weight | kg | 63-75 | 63-75 |

Over
5,000,000
units sold



<https://forklift-manuals.jimdofree.com>

Professional

Innovative design, comprehensive testing and highest quality !

- Most standard and popular model with capacity 2500 - 3500kgs.
- Supporting base : the new type is thicker in case of bending problems.
- Forks: the thickness of the new type is 53mm to make strength increased.
- Great innovation on part of wheel frame:
 - A. The new type wheel frame enhances strength to prevent distortion problems.
 - B. The new type frame without roll ring & roll sheath.
 - C. Adopts double-spring pins construction with strengthening ribbing under triangle to prevent pin snipping problems.
- With Copping Supporting NOG & strengthening ribbing under top triangle cover.
- Complete pump design with reliable leak-proof pump eliminating maintenance and extending the service time.
- 210 steering arc, and small turning radius.
- Fork Lowering speed is controllable, operated by hand control and foot pedal.
- Ergonomic rubber wrapped handle, which is comfortable and convenient to operate.
- Entry / exit roller, more freely travel.
- Equipped with over-load valve, with long service time.
- 3 position hand control - Raise, Lower, Neutral.
- 12 lubrication grease nipples on all movable parts for easy maintenance.
- Adjustable pump cap ensures a long service life.
- Ergonomic large rubber handle with three control lever.
- Option: 1) Nylon wheel, polyurethane wheel, rubber wheel, single fork roller or tandem fork rollers.
2) Fork length: 800mm, 900mm, 1000mm.
3) Foot pedal release.
4) Pump color: black painting, silver painting, silver galvanized.



Adjustable pump cap



Adjustable straight tappet



Option: fully rubber wrapped handle



Entry roller for easy operation
Innovative wheel frame



Conforms to EN ISO3691-5:2009
Based on Directive 2006/42/EC

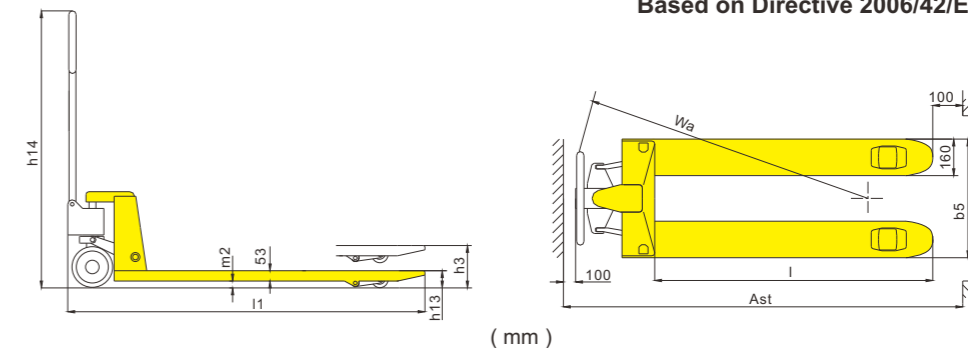

Remark: Special size fork width and length can be made according to customer's requirement.



Model: BF-III

1KG=2.205LB 1INCH=25.40MM

| Model | BF-III | |
|--|---------------|--------------|
| Capacity | Q(kg) | 2500 |
| Lowered fork height | h_{13} (mm) | 75 |
| steering wheel | mm | ϕ 180 |
| fork wheel single | mm | ϕ 74x93 |
| fork wheel double | mm | ϕ 74x70 |
| Max. Lifting height | h_3 (mm) | 195 |
| Height of tiller in drive position min./max. | h_{14} (mm) | 1214 |
| Overall length | l_1 (mm) | 1543/1613 |
| Fork length | l (mm) | 1150/1220 |
| Width overall forks | b_5 (mm) | 520/550/685 |
| Ground clearance, center of wheelbase | m_2 (mm) | 32 |
| Aisle width for pallets 1000x1200 crossways | A_n (mm) | 1743/1813 |
| Aisle width for pallets 800x1200 lengthways | A_n (mm) | 1813/1813 |
| Turning radius | W_s (mm) | 1276/1346 |
| Service weight | kg | 58-70 |

Remark: Special size fork width and length can be made according to customer's requirement.

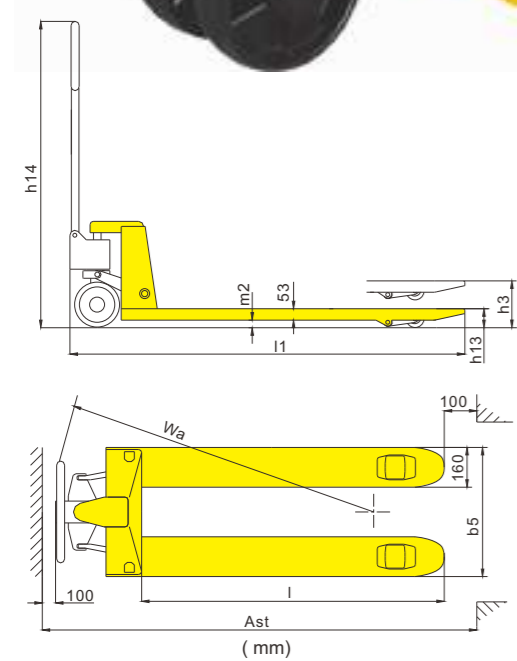

Conforms to EN ISO3691-5:2009
Based on Directive 2006/42/EC



Pump

Hand pallet truck

- Integrated pump without welding , no any leaking problems.
- Frame force is more reasonable , and the strength is more reliable.
- Handle seat has hole it is more convenient for installation of control chain.
- Forks lowering speed is controllable, with overload valve to avoid overloading .
- Option: 1) steering wheel 200mm (fork wheel 80mm) are available.
2) Nylon wheel, polyurethane wheel, rubber wheel, single fork roller or tandem fork rollers.
3) Fork length: 800mm, 900mm, 1000mm, 1100mm.
4) Foot pedal release.
5) Pump color: black painting.
6) Quick lift (double speed lifting).

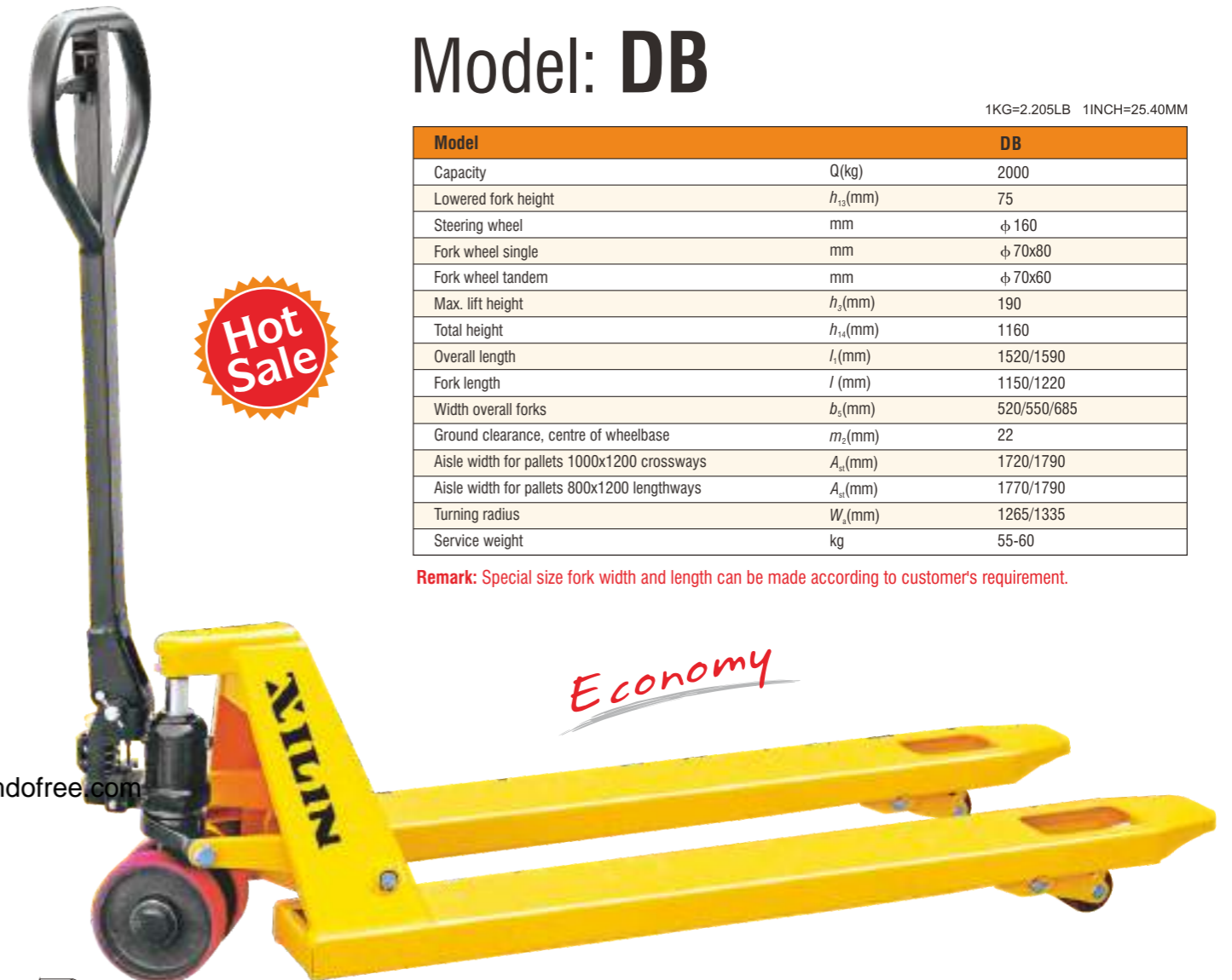

Model: DB

1KG=2.205LB 1INCH=25.40MM

| Model | DB | |
|---|---------------|--------------|
| Capacity | Q(kg) | 2000 |
| Lowered fork height | h_{13} (mm) | 75 |
| Steering wheel | mm | ϕ 160 |
| Fork wheel single | mm | ϕ 70x80 |
| Fork wheel tandem | mm | ϕ 70x60 |
| Max. lift height | h_3 (mm) | 190 |
| Total height | h_{14} (mm) | 1160 |
| Overall length | l_1 (mm) | 1520/1590 |
| Fork length | l (mm) | 1150/1220 |
| Width overall forks | b_5 (mm) | 520/550/685 |
| Ground clearance, centre of wheelbase | m_2 (mm) | 22 |
| Aisle width for pallets 1000x1200 crossways | A_n (mm) | 1720/1790 |
| Aisle width for pallets 800x1200 lengthways | A_n (mm) | 1770/1790 |
| Turning radius | W_s (mm) | 1265/1335 |
| Service weight | kg | 55-60 |

Remark: Special size fork width and length can be made according to customer's requirement.

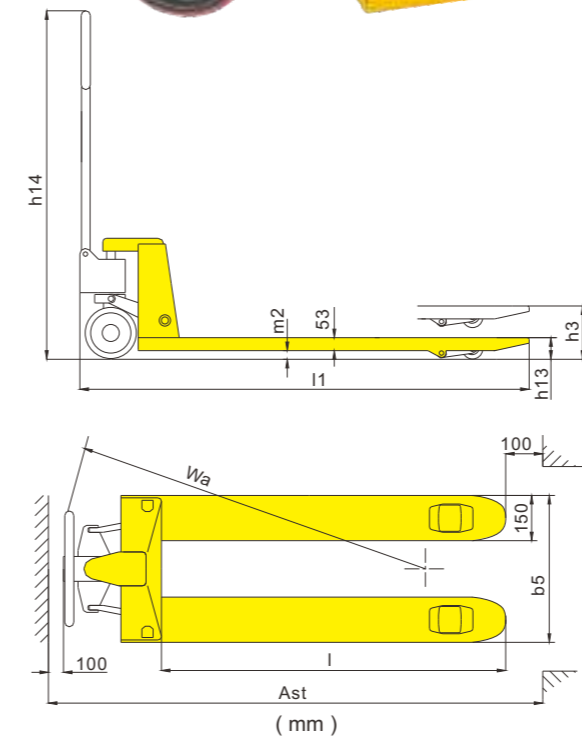

Conforms to EN ISO3691-5:2009
Based on Directive 2006/42/EC

Economic design pallet truck

- Standard epoxy powder coat finish which is resistant to chips and normal corrosion.
- Exceptionally strong but light weight steel construction, service weight is only 55kgs.
- With welded joints and reinforced fork tips for most durability in the toughest applications.
- 3 position hand control - Raise, Lower, Neutral.
- Excellent turning angle of 190 degrees facilities.
- Number of pump strokes 12 times, lift height per stroke 11mm.
- Reliable oil leak-proof hydraulic system.
- Option: 1) Nylon wheel, polyurethane wheel, rubber wheel, single fork roller or tandem fork rollers.
2) Fork length: 800mm, 900mm, 1000mm, 1100mm.

Model: WA 3000KG

1KG=2.205LB 1INCH=25.40MM

| Model | WA | |
|---|---------------|---------------------------|
| Capacity | Q(kg) | 2000/2500/3000 |
| Lowered fork height | h_{13} (mm) | 85 75 |
| Steering wheel | mm | ϕ 200 ϕ 180 |
| Fork wheel single | mm | ϕ 80x93 ϕ 74x93 |
| Fork wheel tandem | mm | ϕ 80x70 ϕ 74x70 |
| Max. lift height | h_2 (mm) | 200 190 |
| Total height | h_{14} (mm) | 1232 1222 |
| Overall length | l_1 (mm) | 1520/1590 1520/1590 |
| Fork length | l (mm) | 1150/1220 1150/1220 |
| Width overall forks | b_2 (mm) | 520/550/685 520/550/685 |
| Ground clearance, centre of wheelbase | m_2 (mm) | 32 22 |
| Aisle width for pallets 1000x1200 crossways | A_{14} (mm) | 1720/1790 1720/1790 |
| Aisle width for pallets 800x1200 lengthways | A_{13} (mm) | 1770/1790 1770/1790 |
| Turning radius | W_2 (mm) | 1265/1335 1265/1335 |
| Service weight | kg | 55-70 55-70 |

Excellent

<https://forklift-manuals.jimdo.com>

Model: DF-III

1KG=2.205LB 1INCH=25.40MM

| Model | | DF | DF-III |
|---|---------------|-----------------------------|---------------------------|
| Capacity | Q(kg) | 2500/3000 | 2500 2500 |
| Lowered fork height | h_{13} (mm) | 85 75 | 85 75 |
| Steering wheel | mm | ϕ 180 ϕ 180 | ϕ 180 ϕ 160 |
| Fork wheel single | mm | ϕ 80x93 ϕ 74x93 | ϕ 70x80 ϕ 70x80 |
| Fork wheel tandem | mm | ϕ 80x70 ϕ 74x70 | ϕ 70x60 ϕ 70x60 |
| Max. lift height | h_2 (mm) | 195 185 | 200 190 |
| Total height | h_{14} (mm) | 1233.5 1223.5 | 1186.5 1176.5 |
| Overall length | l_1 (mm) | 1528.5/1598.5 1528.5/1598.5 | 1590 1520 |
| Fork length | l (mm) | 1150/1220 1150/1220 | 1150/1220 1150/1220 |
| Width overall forks | b_2 (mm) | 520/550/685 520/550/685 | 520/550/680 520/550/680 |
| Ground clearance, centre of wheelbase | m_2 (mm) | 32 22 | 32 22 |
| Aisle width for pallets 1000x1200 crossways | A_{14} (mm) | 1728.5/1798.5 1728.5/1798.5 | 1720/1790 1720/1790 |
| Aisle width for pallets 800x1200 lengthways | A_{13} (mm) | 1778.5/1798.5 1778.5/1798.5 | 1770/1790 1770/1790 |
| Turning radius | W_2 (mm) | 1244.5/1314.5 1244.5/1314.5 | 1265/1335 1265/1335 |
| Service weight | kg | 65-77 65-77 | 55-60kg 55-60kg |

Remark: (1) Capacity 2000kg available.
(2) Special size fork width and length can be made according to customer's requirement.



Standard type pallet truck

- Chrome piston and ram for smooth operation and prevents excessive wear on the pump & seal.
- Excellent turning angle of 180 degrees facilities.
- Number of pump strokes-10. Lift height per stroke:11mm.
- Option: 1) Nylon wheel, polyurethane wheel, rubber wheel, single fork roller or tandem fork rollers.
2) Fork length: 800mm, 900mm, 1000mm.

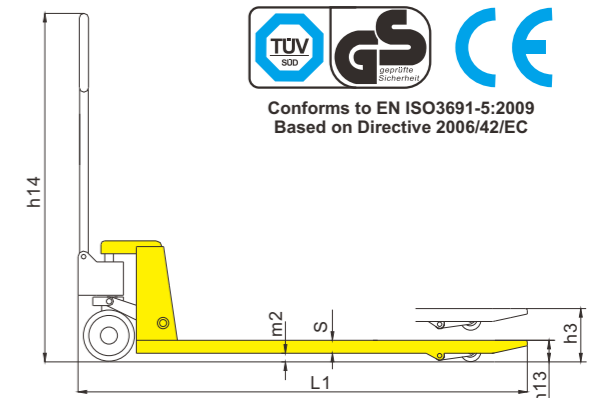

Model: DF

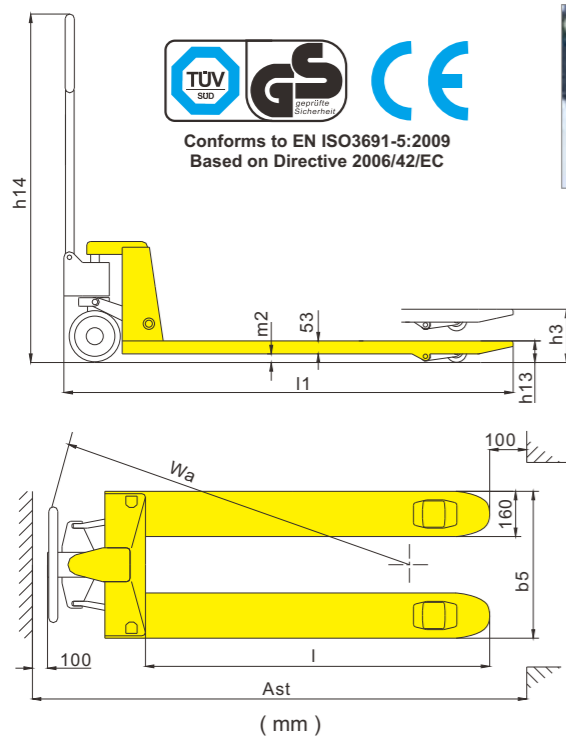
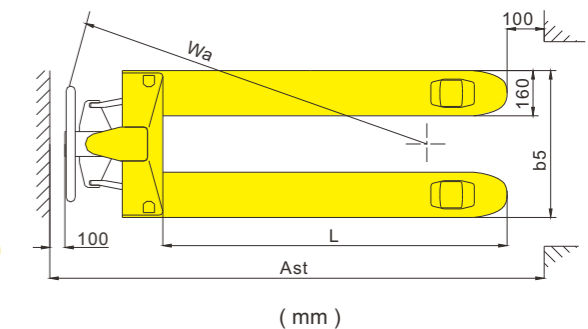

Excellent type pallet truck

- Standard single speed pump and light service weight, but big load capacity 3000kgs.
- Design on the base of 3 years service time, which can be extended up to 5 years.
- Compact appearance, complete rocker arms, ensure the whole truck averaged pressed.
- Full sealed pump, easy to maintain.
- Simplified spare parts, higher performance with low repair cost.
- Option: 1) Double Speed Pump.
2) Nylon wheel, polyurethane wheel, rubber wheel, single fork roller or tandem fork rollers.
3) Fork length: 800mm, 900mm, 1000mm, 1100mm.

Model: NF

1KG=2.205LB 1INCH=25.40MM

| Model | NF | |
|---|---------------|---------------------------|
| Capacity | Q(kg) | 2500 2500 |
| Lowered fork height | h_{13} (mm) | 85 75 |
| Steering wheel | mm | ϕ 200 ϕ 180 |
| Fork wheel single | mm | ϕ 83x81 ϕ 74x93 |
| Fork wheel tandem | mm | ϕ 83x60 ϕ 74x70 |
| Max. lift height | h_3 (mm) | 195 185 |
| Total height | h_{14} (mm) | 1160.5 1160.5 |
| Overall length | l_1 (mm) | 1545/1615 1545/1615 |
| Fork length | l (mm) | 1150/1220 1150/1220 |
| Width overall forks | b_2 (mm) | 520/550/685 520/550/685 |
| Ground clearance, centre of wheelbase | m_2 (mm) | 32 22 |
| Aisle width for pallets 1000x1200 crossways | A_w (mm) | 1745/1815 1745/1815 |
| Aisle width for pallets 800x1200 lengthways | A_w (mm) | 1795/1815 1795/1815 |
| Turning radius | W_s (mm) | 1280/1350 1280/1350 |
| Service weight | kg | 75-102 75-102 |

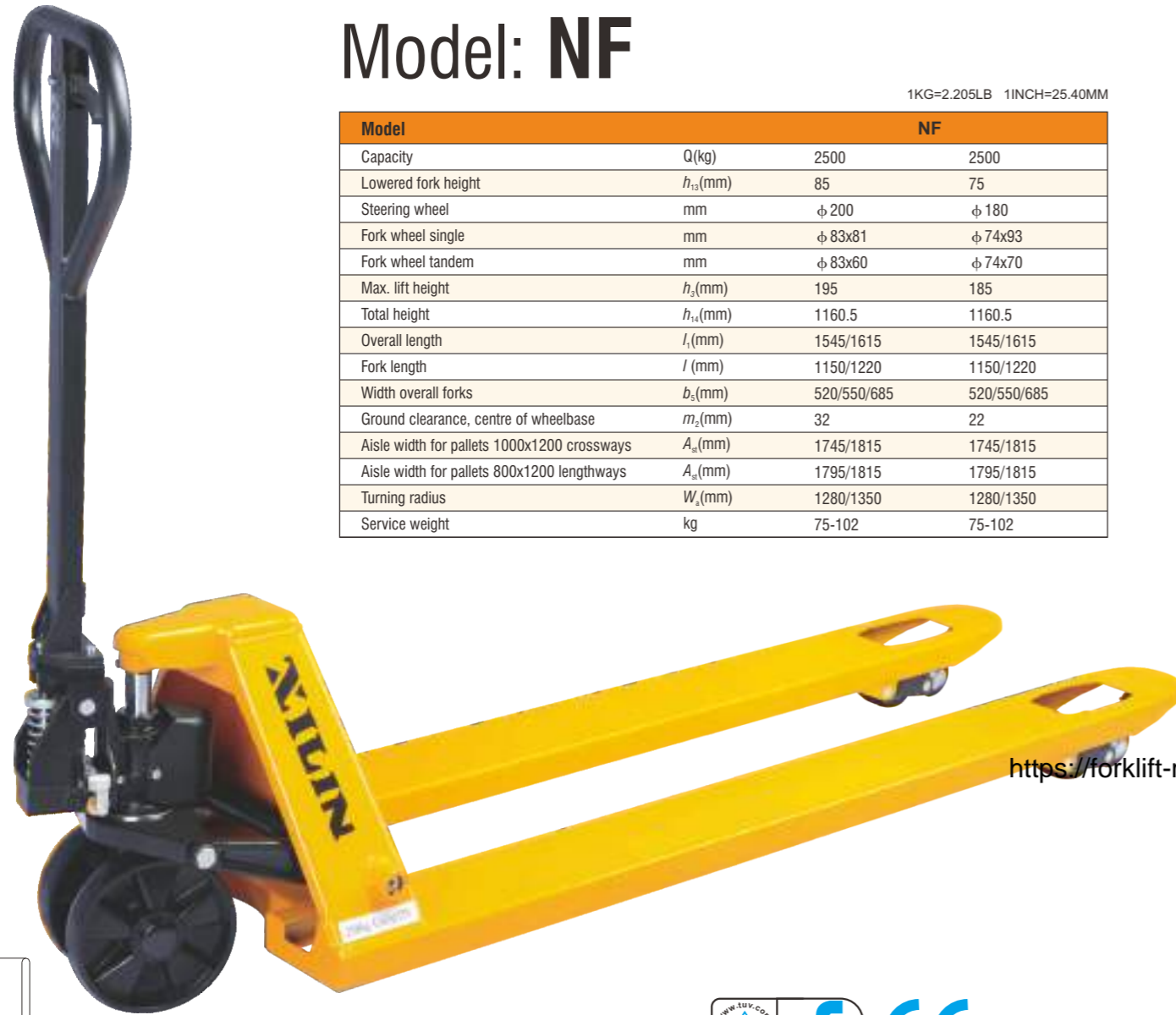

<https://forklift-manuals.jimdofree.com>



Conform to EN ISO3691-5:2009
Based on Directive 2006/42/EC

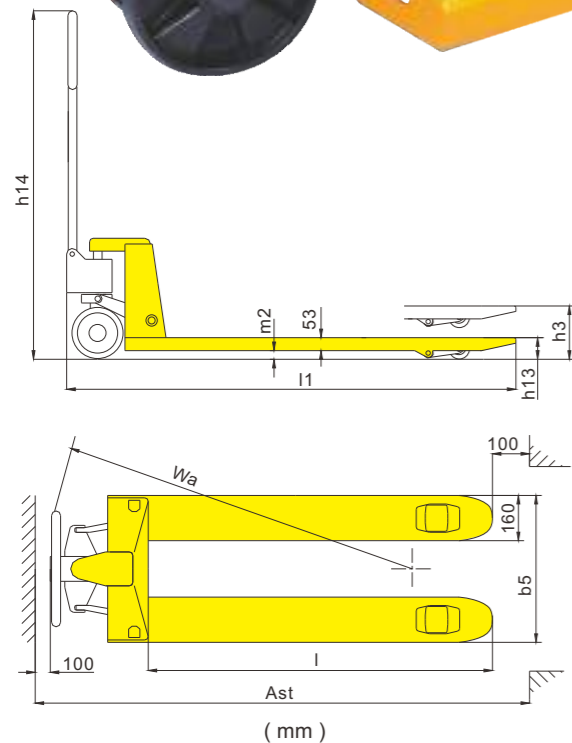

Standard type pallet truck

- Most compact and popular design of pump unit.
- Standard versions for finished using a tough epoxy based coating which is resistant to chips and normal corrosion.
- Heavy duty forks for greatest strength, durability and super strong frame.
- 3 position control lever Lifting-Neutral-Lowering hydraulic encased in protective steel housing.
- Excellent turning angle of 180 degree facilities.
- Option: 1) Nylon wheel, polyurethane wheel, rubber wheel, single fork roller or tandem fork rollers.
2) Fork length: 800mm, 900mm, 1000mm, 1100mm.
3) BF chassis.

Model: WB 5000KG

1KG=2.205LB 1INCH=25.40MM

| Model | WB | |
|---|---------------|---------------------------|
| Capacity | Q(kg) | 5000 5000 |
| Lowered fork height | h_{13} (mm) | 88 78 |
| Steering wheel | mm | ϕ 200 ϕ 180 |
| Fork wheel single | mm | ~ ~ |
| Fork wheel tandem | mm | ϕ 85x80 ϕ 75x80 |
| Max. lift height | h_3 (mm) | 205 195 |
| Total height | h_{14} (mm) | 1253 1243 |
| Overall length | l_1 (mm) | 1544/1614 1544/1614 |
| Fork length | l (mm) | 1150/1220 1150/1220 |
| Width overall forks | b_2 (mm) | 550/685 550/685 |
| Ground clearance, centre of wheelbase | m_2 (mm) | 24 14 |
| Aisle width for pallets 1000x1200 crossways | A_w (mm) | 1744/1814 1744/1814 |
| Aisle width for pallets 800x1200 lengthways | A_w (mm) | 1794/1814 1794/1814 |
| Turning radius | W_s (mm) | 1300/1370 1300/1370 |
| Service weight | kg | 103-110 103-110 |



Heavy Duty

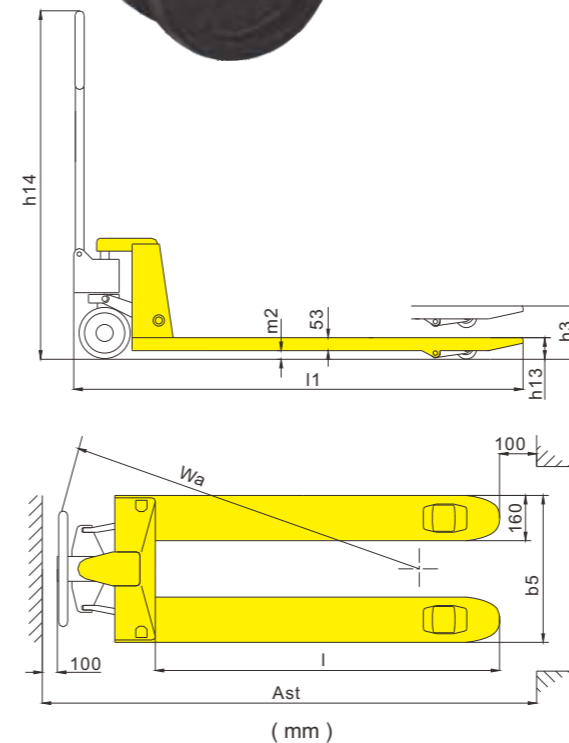

Heavy duty type pallet truck

- High reliability and long service life of 5 years.
- Double lifting speed when loads under 600kg, which turns back to regular speed when above it.
- Impact free lifting ensures safety of cargo loading.
- The lifting system is equipped with overloading protection valve to ensure the safe operation.
- The utilized structural design guarantees the convenience of assembling and disassembling.
- Light-weight fork frame, made from high rigidity steel plate.
- Compact appearance, complete rocker arm, ensure the whole truck evenly pressed.
- There is a finger hole in the connection of handle and pump, easy to assemble.

Multi-function Hand Pallet Truck



Conforms to EN ISO3691-5:2009
Based on Directive 2006/42/EC

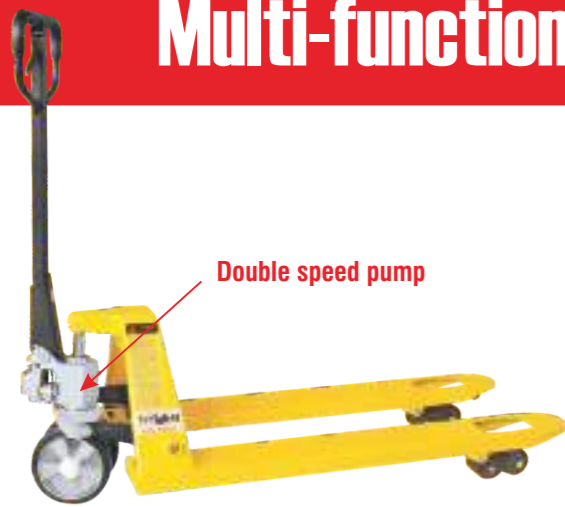

Model: BFAQ

Quick Lift Model

- The quick lift pallet truck is an ideal truck for light load handling.
- Whenever lifting loads under 300kg, it takes just 5 strokes reached max. height.
- For loads above 300 kg, the quick lift hydraulic system automatically switches to normal operation.



Model: BFB

Pallet Truck With Brake System

- Pallet truck with brake system can conveniently cease the truck and navigate ramps.



Model: BFT

Traverse Pallet Truck

- Designed for moving long loads down narrow aisles.
- Traverse movement effects when the fork height up to 180mm, and turn the handle by an angle of 90 degrees.
- Traverse movement provides more flexibility and convenience of applications as condition changes.
- Load capacity: 2500kg (1500kg traverse traveling).

1KG=2.205LB 1INCH=25.40MM

| Model | | BFAQ | BFB | BFT |
|---|---------------|------------------|------------------|-------------------------------|
| Capacity | Q(kg) | 2500 | 2500 | 2500 (1500 traverse) |
| Lowered fork height | h_{13} (mm) | 85/75 | 85/75 | 85/75 |
| Steering wheel | mm | φ 200/ φ 180 | φ 200/ φ 180 | φ 200/ φ 180 |
| Fork wheel single | mm | φ 80x93/ φ 74x93 | φ 80x93/ φ 74x93 | φ 80x70/ φ 74x70 (fork wheel) |
| Fork wheel tandem | mm | φ 80x70/ φ 74x70 | φ 80x70/ φ 74x70 | φ 65x60 (traverse wheel) |
| Max. lift height | h_2 (mm) | 200/190 | 200/190 | 200/190 |
| Total height | h_{14} (mm) | 1224 | 1224 | 1224 |
| Overall length | l_1 (mm) | 1533/1603 | 1533/1603 | 1533/1603 |
| Fork length | l (mm) | 1150/1220 | 1150/1220 | 1150/1220 |
| Width overall forks | b_2 (mm) | 520/550/685 | 550/685 | 520/550/685 |
| Ground clearance, centre of wheelbase | m_2 (mm) | 32/22 | 32/22 | 32/22 |
| Aisle width for pallets 1000x1200 crossways | A_s (mm) | 1733/1803 | 1733/1803 | 1733/1803 |
| Aisle width for pallets 800x1200 lengthways | A_s (mm) | 1783/1803 | 1783/1803 | 1783/1803 |
| Turning radius | W_s (mm) | 1266/1336 | 1266/1336 | 1266/1336 |
| Service weight | kg | 65-85 | 65-85 | 65-85 |



Model: BFL

Low-profile Pallet Truck

- 1.5T Cap. lowered fork height - 52mm.
- 1T Cap. lowered fork height - 35mm.
- Steel fork rollers.



Model: BFH

High-profile Pallet Truck



Model: BFS

Stainless Steel Pallet Truck

- Widely used in carrying meat, marine products, wines, beverage, chemicals, etc. and can work in very low temperature conditions, e.g. to deliver goods into and out of freezers/coolers.



Model: BFG

Galvanized Pallet Truck

<https://forklift-manuals.jimdofree.com>

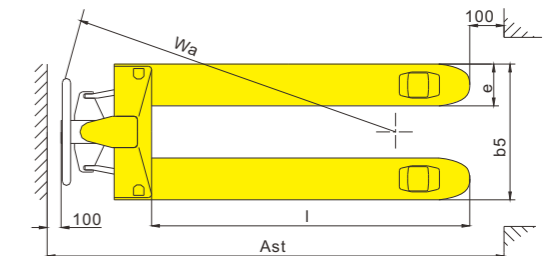
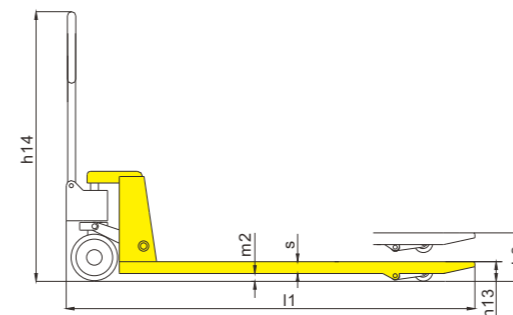

1KG=2.205LB 1INCH=25.40MM

| Model | | BFL10 | BFL15 | BFH | BFS | BFG |
|---|---------------|-------------------|-------------------|-------------------|-------------------|-------------------|
| Capacity | Q(kg) | 1000 | 1500 | 2000 | 2500 | 2500 |
| Lowered fork height | h_{13} (mm) | 35 | 52 | 140 | 85/75 | 85/75 |
| Steering wheel | mm | φ 150 | φ 150 | φ 180 | φ 200/ φ 180 | φ 200/ φ 180 |
| Fork wheel single | mm | ~ | φ 50x93 | φ 126x68 | φ 74x93 | φ 80x93/ φ 74x93 |
| Fork wheel tandem | mm | φ 35x60 | φ 50x70 | ~ | φ 74x70 | φ 80x70/ φ 74x70 |
| Max. lift height | h_2 (mm) | 105 | 140 | 255 | 200/190 | 200/190 |
| Total height | h_{14} (mm) | 1174 | 1189 | 1279 | 1224 | 1224 |
| Overall length | l_1 (mm) | 1533/1603 | 1547/1617 | 1533/1603 | 1533/1603 | 1533/1603 |
| Fork dimensions | s/e/l | 28/150/1150(1220) | 38/150/1150(1220) | 53/160/1150(1220) | 45/160/1150(1220) | 53/160/1150(1220) |
| Width overall forks | b_2 (mm) | 520/550/685 | 520/550/685 | 520/550/685 | 520/550/685 | 520/550/685 |
| Ground clearance, centre of wheelbase | m_2 (mm) | 7 | 14 | 95 | 32/22 | 32/22 |
| Aisle width for pallets 1000x1200 crossways | A_s (mm) | 1733/1803 | 1747/1817 | 1733/1803 | 1733/1803 | 1733/1803 |
| Aisle width for pallets 800x1200 lengthways | A_s (mm) | 1783/1803 | 1797/1817 | 1783/1803 | 1783/1803 | 1783/1803 |
| Turning radius | W_s (mm) | 1266/1336 | 1286/1356 | 1266/1336 | 1266/1336 | 1266/1336 |
| Service weight | kg | 65-80 | 65-80 | 70-80 | 65-80 | 65-80 |

Multi-function Hand Pallet Truck



Model: BF3500
Heavy Duty Truck

1KG=2.205LB 1INCH=25.40MM

| Model | BF3500 | |
|---------------------|--------|--------------|
| Capacity | (kg) | 3500 |
| Lowered fork height | (mm) | 85/75 |
| Total lift height | (mm) | 200/190 |
| H. of handleless | (mm) | 443/433 |
| Fork length | (mm) | 1150/1220 |
| Width overall forks | (mm) | 550/685 |
| Steering wheel | (mm) | φ 200/ φ 180 |
| Fork wheel | (mm) | φ 80/ φ 74 |
| Truck weight | (kg) | 100 |



Model: BFR
Pallet Truck With Backrest

1KG=2.205LB 1INCH=25.40MM

| Model | BFR | |
|---------------------|------|--------------|
| Capacity | (kg) | 2500 |
| Lowered fork height | (mm) | 85/75 |
| Total lift height | (mm) | 200/190 |
| H. of handleless | (mm) | 431.5/421.5 |
| Fork length | (mm) | 1150/1220 |
| Width overall forks | (mm) | 520/550/685 |
| Steering wheel | (mm) | φ 200/ φ 180 |
| Fork wheel | (mm) | φ 80/ φ 74 |
| Truck weight | (kg) | 95/105 |

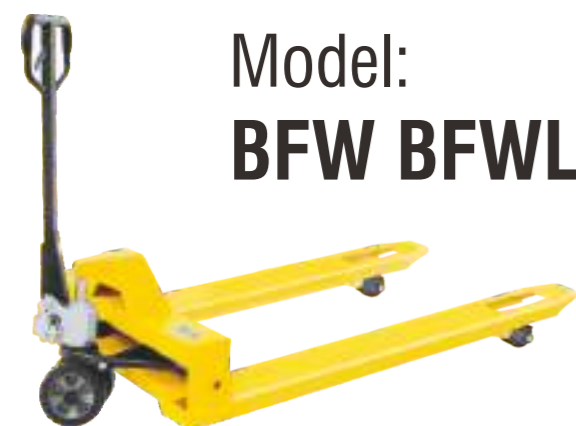

Model: BFW BFWL

1KG=2.205LB 1INCH=25.40MM

| Model | BFW | BFWL | |
|---------------------|------|----------------------------|-----------|
| Capacity | (kg) | 1500 | 1500 |
| Lowered fork height | (mm) | 85/75 | 52 |
| Total lift height | (mm) | 200/190 | 142 |
| H. of handleless | (mm) | 431.5/421.5 | 421.5 |
| Fork length | (mm) | 1150/1220 | 1150/1220 |
| Width overall forks | (mm) | 740/830/965/1000/1200/1400 | |
| Steering wheel | (mm) | φ 200/ φ 180 | φ 150 |
| Fork wheel | (mm) | φ 80/ φ 74 | φ 50 |
| Truck weight | (kg) | 100 | 100 |



Model: BFZ
Super Narrow Truck

1KG=2.205LB 1INCH=25.40MM

| Model | BFZ | |
|---------------------|------|-------------|
| Capacity | (kg) | 2000 |
| Lowered fork height | (mm) | 75 |
| Total lift height | (mm) | 190 |
| H. of handleless | (mm) | 401.5 |
| Fork length | (mm) | 800 |
| Width overall forks | (mm) | 320/390/406 |
| Steering wheel | (mm) | φ 160 |
| Fork wheel | (mm) | φ 70 |
| Truck weight | (kg) | 65 |



Model: WF
MINI Pallet Truck



Conforms to EN ISO3691-5:2009
Based on Directive 2006/42/EC

Only 35kg!

1KG=2.205LB 1INCH=25.40MM

| Model | WF | |
|---------------------|---------------|------------|
| Capacity | Q(kg) | 500 |
| Lowered fork height | h_{10} (mm) | 60 |
| Steering wheel | mm | φ 127 |
| Fork wheel | mm | φ 58 |
| Max. lift height | h_3 (mm) | 150 |
| Total height | h_{14} (mm) | 1110 |
| Overall length | l_1 (mm) | 1126 |
| Fork dimensions | s/e/l | 40/100/800 |
| Width overall forks | b_3 (mm) | 380 |
| Service weight | kg | 35 |



Model: BFJ
Reel Carrier Truck

1KG=2.205LB 1INCH=25.40MM

| Model | BFJ | |
|-------------------------|------|--------------|
| Capacity | (kg) | 1000 |
| Diameter of bale | (mm) | φ 700~φ 1200 |
| Height of handleless | (mm) | 431.5 |
| Fork length | (mm) | 1150 |
| Max width overall forks | (mm) | 965 |
| Steering wheel | (mm) | φ 200 |
| Fork wheel | (mm) | φ 80 |
| Weight | (kg) | 135 |

<https://forklift-manuals.jimdofree.com>



Model: HW
Rough Terrain Truck
• Special for building site

1KG=2.205LB 1INCH=25.40MM

| Model | HW | |
|---------------------------|------|-----------|
| Capacity | (kg) | 1500 |
| Lowered fork height | (mm) | 70 |
| Total lift height | (mm) | 240 |
| Height of handleless | (mm) | 734 |
| Total height | (mm) | 1298 |
| Total width | (mm) | 1605 |
| Fork length | (mm) | 800 |
| Max width overall forks | (mm) | 740 |
| Least width overall forks | (mm) | 226 |
| Steering wheel | (mm) | φ 250x60 |
| Fork wheel | (mm) | φ 380x114 |
| Weight | (kg) | 192 |



• Different fork size can be made according to customers' requirement.

Pallet Truck Stop

Model: PTS

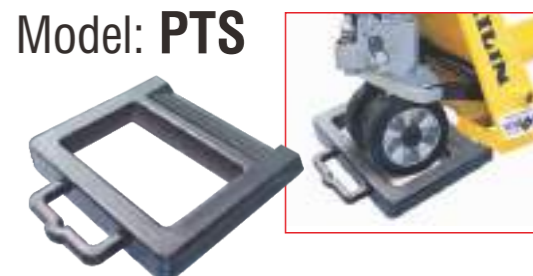

- "Pallet Truck Stop" is designed to eliminate damage due to runaway pallet Jacks, which can be easily picked up and placed in convenient spots.
- Drivers will never again have to tie down a pallet jack, use a load bar to hold it or flip it on its side. Just pull the jack into the pallet truck stop and it's parked in less than two seconds fully secured.
- It is the best device designed to hold any pallet Jacks in a moving car or trailer.

Model: **BFC6**
Model: **BFC6-II**
(Scale pallet truck with printer)



Model: **BFC6-7**
Model: **BFC6-8**
(Scale pallet truck with printer)



Standard <https://forklift-manuals.jimdofree.com>

Model: **BFC6-IV**
(Lifting truck with electronic mobile scale)

- Display with dry batteries, no power supply, it is environment-friendly.
- Applicable for weighing in lifting.
- With bush on key parts, quality is more reliable.



Smart



Conforms to EN ISO3691-5:2009
Based on Directive 2006/42/EC

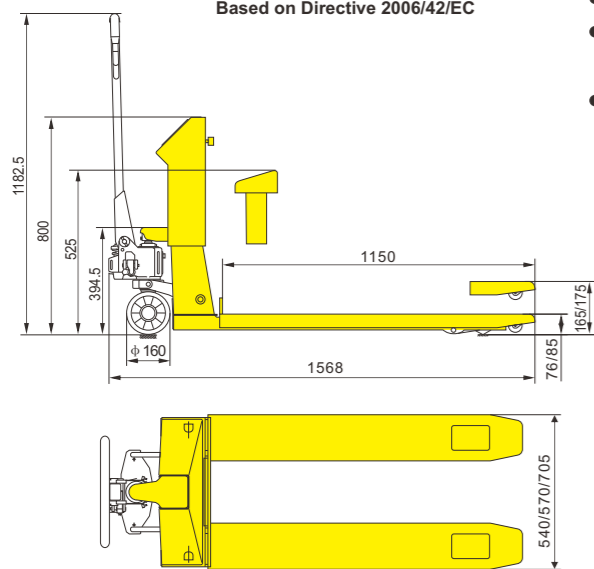

- Mobile pallet truck with scale combined two major functions for pallet truck/scale, allows you to weigh cargo whatever, wherever, whenever you want.
- Power supply with **rechargeable battery** or with 86~264V AC input .
- Keypad and automatic tare functions.
- 1.2inches, super-large and bright LED display in solid state to be strike-free.
- Available in pounds or kilograms.
- A/D velocity: 27/s, a faster speed of weighing, more correct.
- Various functions: with extended functions as weight-checking ,counting, etc., to satisfy different needs of customers.
- Conforms to EU's ROHS standard.

1KG=2.205LB 1INCH=25.40MM

| Model | | BFC6/BFC6-II | BFC6-7/BFC6-8 |
|---------------------|------|---------------------------------------|-------------------|
| Capacity | (kg) | 2000 | 2000 |
| Lowered fork height | (mm) | 76/85 | 76/85 |
| Total lift height | (mm) | 165/175 | 165/175 |
| Fork length | (mm) | 1150 | 1150 |
| Width overall forks | (mm) | 540/570/705 | 540/570/705 |
| Steering wheel | (mm) | φ 160 | φ 160 |
| Fork wheel | (mm) | φ 70 | φ 70 |
| Power | | Dry cell / Ni MH rechargeable battery | Lead-acid battery |
| Measuring interval | | 0.5 | 0.5 |
| Max. deviation | (kg) | ± 1‰ | ± 1‰ |
| Service weight | (kg) | 135 | 130 |

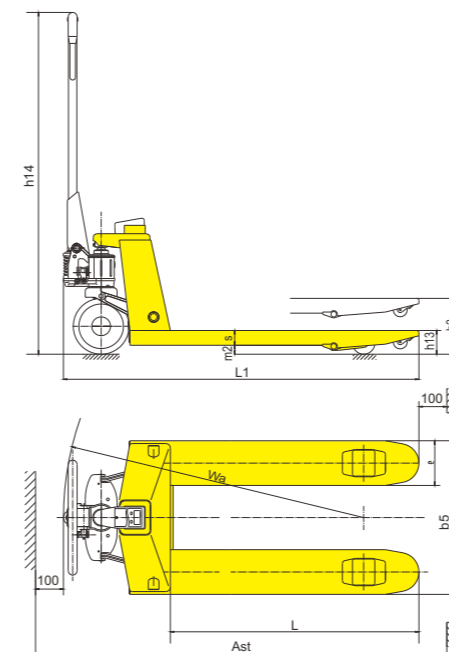

| Model | BFC6-IV | | |
|---|---------------|----------------|----------------|
| | 1KG=2.205LB | 1INCH=25.40MM | |
| Capacity | kg | 2000/2500 | 2000/2500 |
| Lowest fork height | mm | 85 | 75 |
| Steering wheel | mm | φ 200 | φ 180 |
| Fork wheel single | mm | φ 80 | φ 74 |
| Max lifting height | h_3 (mm) | 200 | 190 |
| Total height | h_{14} (mm) | 1224 | 1214 |
| Height without handle | mm | 486 | 476 |
| Fork length | l(mm) | 1100/1150/1220 | |
| Width overall forks | b5(mm) | 520/550/680 | 520/550/680 |
| Ground clearance, center of wheelbase | m_2 (mm) | 32 | 22 |
| Aisle width for pallets 1000x1200 crossways | A_{cr} (mm) | 1683/1733/1803 | 1683/1733/1803 |
| Aisle width for pallets 800x1200 lengthways | A_{lr} (mm) | 1783/1783/1803 | 1783/1783/1803 |
| Turning radius | W_r (mm) | 1216/1266/1336 | 1216/1266/1336 |
| Service Weight | kg | 60-80 | 60-80 |

Scale Pallet Truck

High Lift Truck



Model: BFC6-7(S)

Stainless Steel Scale Truck

1KG=2.205LB 1INCH=25.40MM

| Model | BFC6-7(S) | |
|---------------------|-------------------|-------------|
| Capacity | (kg) | 2000 |
| Lowered fork height | (mm) | 76/85 |
| Total lift height | (mm) | 165/175 |
| Fork length | (mm) | 1150 |
| Width overall forks | (mm) | 540/570/705 |
| Steering wheel | (mm) | φ 160 |
| Fork wheel | (mm) | φ 70 |
| Power | Lead-acid battery | |
| Measuring interval | 0.5 | |
| Max. deviation | (kg) | ± 1‰ |
| Service weight | (kg) | 130 |

1KG=2.205LB 1INCH=25.40MM

| MODEL | CBD20K(C) | |
|--|------------------|------------------------|
| Drive | electric | |
| Load capacity/rated load | Q(kg) | 2000 |
| Load centre distance | c(mm) | 600 |
| Fork Height, lowered | h_{13} (mm) | 82 |
| Tyres | polyurethane | |
| Tyre size, front | Φ 250x70 | |
| Tyre size rear | Φ 82x126 | |
| Additional wheels(dimensions) | Φ 127 | |
| Max. lift height | h_3 (mm) | 120 |
| Height of tiller in drive position min./max. | h_{14} (mm) | 780/1230 |
| Overall length | l_1 (mm) | 1673/1723/1793 |
| Length to face of forks | l_2 (mm) | 573 |
| Overall width | b_1 (mm) | 775 |
| Fork dimensions | s/e/l(mm) | 54x186x1100(1150/1220) |
| Width overall forks | b_3 (mm) | 556/656/691 |
| Travel speed,laden/unladen | Km/h | 5.5/5.6 |
| Gradeability,laden/unladen | % | 6/12 |
| Max.gradeability,laden/unladen | % | 8/20 |
| Service brake | Electro magnetic | |
| Battery voltage,nominal capacity K5 | V/Ah | 24/165(210) |
| Battery weight | Kg | 170 |
| Battery box dimensions | mm | 750x170x474(534) |
| Service weight(without battery) | kg | 690 |

Model: CBD20K(C)

Electric Pallet Truck with Scale



TOLEDO meter
Weighing accuracy ± 2‰

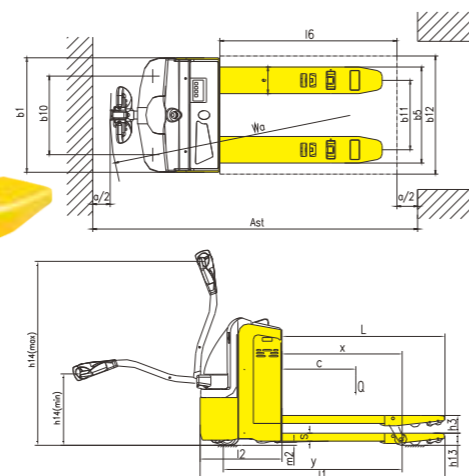

Model: JF



Conforms to EN 1757-4:2004
Based on Directive 2006/42/EC

- Ideal design with numerous possibilities makes this unit very suitable as pallet truck/scissor lift table.
- Telescopic jack composes of 3 piston rods
 - creating light pumping force giving great rigidity.
 - Support legs come into operation automatically.
 - It prevents the unit from moving when the forks are raised to keep the safety of the operator.
 - Truck automatically slows the descending speed when heavy goods loaded to prevent cargo damage.
 - 210 degree turning radius.
 - 2 lateral stabilizers when raised ensure good stability.

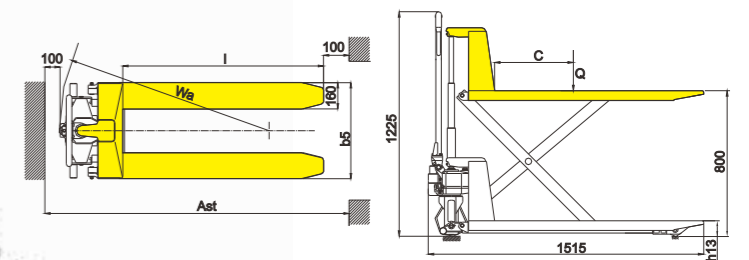

1KG=2.205LB 1INCH=25.40MM

| Model | JF | JF7 | |
|---|---------------|-------------|----------|
| Capacity | Q(kg) | 1000 | 1000 |
| Lowered fork height | h_{13} (mm) | 85 | 85 |
| Steering wheel | mm | Φ 180X50 | Φ 180X50 |
| Fork wheel | mm | Φ 74X50 | Φ 74X50 |
| Fork length | l (mm) | 1150 | 1220 |
| Width overall forks | b_3 (mm) | 520/550/685 | 550/685 |
| Aisle width for pallets 1000x1200 crossways | A_{10} (mm) | 1715 | 1985 |
| Aisle width for pallets 800x1200 lengthways | A_{11} (mm) | 1765 | 1985 |
| Turning radius | W_1 (mm) | 1360 | 1670 |
| Service weight | kg | 108-112 | 112 |

Model: JF7



- Improved safety: Automatic activation of self adjusting stabilizers when lifting loads higher than 400 mm for maximum stability .
- Great stability: Extra long front legs increase the stability when handling unevenly loaded pallets.
- Quick-lift operation: Quick-lift function doubles the lifting speed when lifting loads less than 250kg.

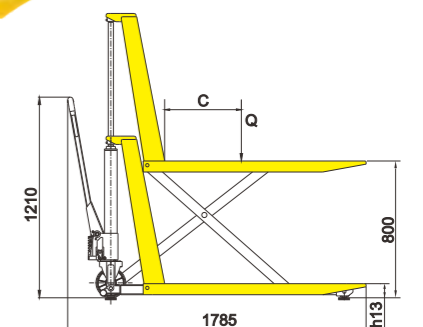

Electric High Lift Truck



Conforms to EN 1757-4:2003
Based on Directive 2006/42/EC

Model: **JFD8**



<https://forklift-manuals.jimdofree.com>

1KG=2.205LB 1INCH=25.40MM

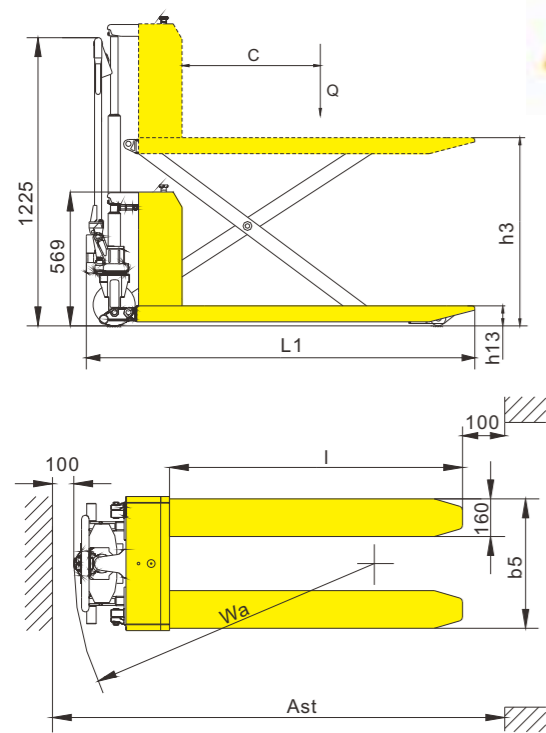

| Model | JFD8 | |
|---|---------------|----------------------|
| Capacity | Q(kg) | 1000 |
| Lowered fork height | h_{13} (mm) | 85 |
| Steering wheel | mm | $\Phi 180 \times 50$ |
| Fork wheel | mm | $\Phi 74 \times 50$ |
| Max. lift height | h_3 (mm) | 800 |
| Overall length | L_1 (mm) | 1652 |
| Fork length | l (mm) | 1245 |
| Width overall forks | b_5 (mm) | 550/685 |
| Aisle width for pallets 1000x1200 crossways | A_c (mm) | 1852 |
| Aisle width for pallets 800x1200 lengthways | A_d (mm) | 1852 |
| Turning radius | W_s (mm) | 1480 |
| Lift motor rating at S3 15% | kW | 0.7 |
| Battery voltage,nominal capacity K10 | V/Ah | 12/100 |
| Battery weight | kg | 31 |
| Service weight (with battery) | kg | 181 |

Electric Pallet Truck

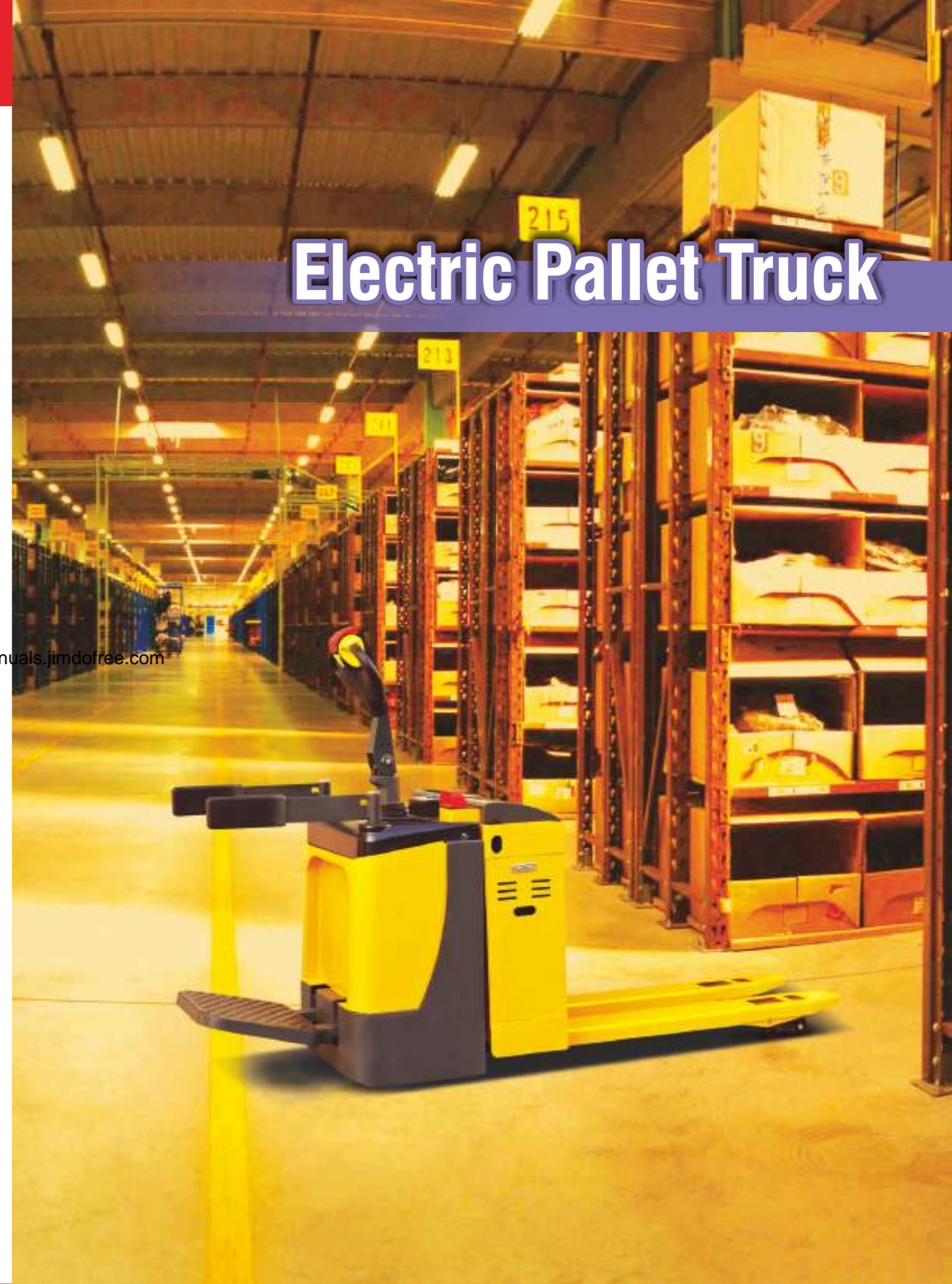

Semi-electric Pallet Truck



Model: CBD15A/CBD20A



Conforms to EN 1757-2
EN ISO 14121-1
Based on Directive 2006/42/EC



Advantages:

- Permanent magnet brushless motor with high electric efficiency, maintenance free.
- Gradient performance is high.
- With smallest turning radius.
- Full sealed battery free to maintain, big capacity 24v/65AH fit for high intensity use.
- Traction speed is consistency under laden or unladen, improve productive efficiency.
- Horizontal drive wheel provides convenient replacement.
- Stepless speed control.
- Floating balance wheel is automatic adjust height, prevents shaking when unload.
- Built-in charger.

<https://forklift-manuals.jimdofree.com>

1KG=2.205LB 1INCH=25.40MM

| MODEL | | CBD10A- II | CBD15A | CBD20A |
|--|---------------|-------------------|-------------------|-------------------|
| Load capacity | Q(kg) | 1000 | 1500 | 2000 |
| Load centre distance | c(mm) | 500 | 600 | 600 |
| Fork height, lowered | h_{13} (mm) | 85/75 | 85/75 | 87/77 |
| Wheelbase | y(mm) | 1280/1350 | 1287/1357 | 1277/1347 |
| Tyre size, front | mm | Φ185 | Φ195 | Φ195 |
| Tyre size, rear | mm | Φ80/Φ74 | Φ80/Φ74 | Φ85/Φ75 |
| Max. lift height | h_5 (mm) | 200/190 | 190/180 | 190/180 |
| Height of tiller in drive position min./max. | h_{14} (mm) | 1244 | 770/1254 | 770/1254 |
| Overall length | l_1 (mm) | 1685/1755 | 1644/1714 | 1644/1714 |
| Length to face of forks | l_2 (mm) | 535 | 490 | 490 |
| Fork dimensions | s/e/l(mm) | 45/160/1150(1220) | 53/160/1150(1220) | 60/160/1150(1220) |
| Width overall forks | b_5 (mm) | 520/550/680 | 520/550/685 | 520/550/680 |
| Ground clearance, centre of wheelbase | m_2 (mm) | 40/30 | 32/22 | 27/17 |
| Aisle width for pallets 1000x1200 crossways | A_{sf} (mm) | 1885/1955 | 1844/1914 | 1844/1914 |
| Aisle width for pallets 800x1200 lengthways | A_{sf} (mm) | 1935/1955 | 1894/1914 | 1894/1914 |
| Turning radius | W_s (mm) | 1490/1560 | 1445/1515 | 1445/1515 |
| Travel speed, laden/unladen | Km/h | 2.6/3.8 | 5.3/5.8 | 5/5.5 |
| Max. gradeability, laden/unladen | % | 5/15 | 5/15 | 3/10 |
| Battery voltage, nominal capacity K5 | V/Ah | 24/38 | 24/65 | 24/80 |
| Battery weight | Kg | 26 | 46 | 51.2 |
| Service weight (with battery) | Kg | 150 | 200 | 240 |



Patent product

Model: CBD10A-II

Advantages:

- Two-speed driving system.
- Emergency brake switch.
- Manual lifting and motor driving.
- DC motor, no carbon brush, maintenance free, low noise.
- Sealed batteries free of maintenance, safe operation and no pollution.
- Built-in charger.



Conforms to EN 1757-2
EN ISO 14121-1
Based on Directive 2006/42/EC

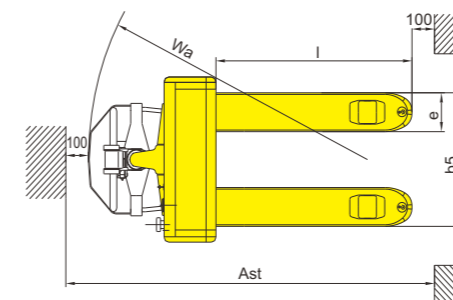
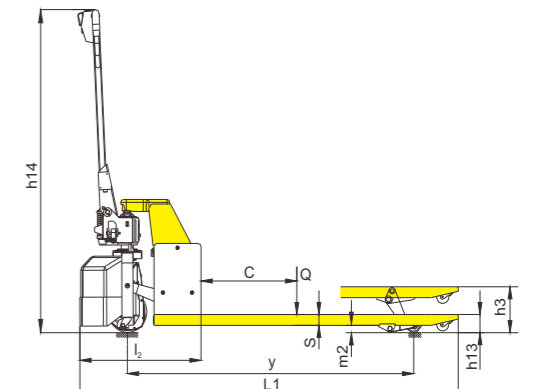
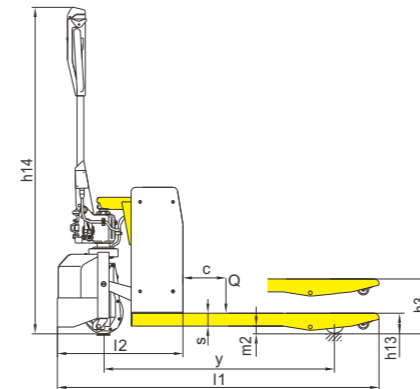

CBD15A/20A

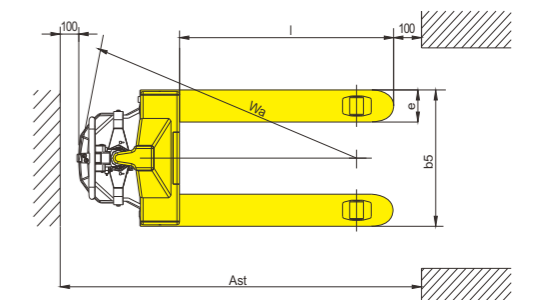

CBD10A-II

Electric Pallet Truck



Model: CBD15W



Conforms to EN 1175-2:1998+A1:2010
 EN ISO3691-1:2012
 Based on Directive 2006/42/EC

The Mini type CBD15W (1500kg) with same size as hand pallet truck widely used in narrow aisle workshop, small super market and cargo containers.

AC
EPS



<https://forklift-manuals.jimdofree.com>



Standard Handle



Frei tiller head (option)



Multi-direction display

Advantages:

- With smallest turning radius 1320mm-1389mm (width 520/550/685mm)
- Permanent magnet brushless motor with high electric efficiency , maintenance free.
- Full sealed battery free to maintain, big capacity 24v/80AH fit for high intensity use .
- Max speed limit button can release brake when handle under upright position, reduce turning space greatly. (option for frei handle)
- High travel speed is up to 5.3-5.8km/h, improve productive efficiency.
- Floating balance wheel is automatic adjust height, prevents shaking when unload.
- Horizontal drive wheel provides convenient replacement.

Standard Features

- RUYI new type Tiller Head with Max speed limit button.
- Emergency stop & belly button.
- BDI and hour meter.
- Casters to balance stability.
- Sealed battery.
- Brushless Horizontal motor.
- Built-in Charger.
- Exist roller.

Option

- Germany FREI Tiller Head.
- Out side charger.
- Fork width and length (size).
- Load backrest.

1KG=2.205LB 1INCH=25.40MM

| MODEL | | CBD15W |
|--|---------------|-------------------|
| Drive type | | electric |
| Operation type | | pedestrian |
| Load capacity | Q(kg) | 1500 |
| Fork height,lowered | h_{10} (mm) | 85/75 |
| Wheelbase | Y(mm) | 1152/1222 |
| Tyre | | polyurethane |
| Tyre size,front | mm | Φ195 |
| Tyre size,rear | mm | Φ80/Φ74 |
| Wheels, number front rear (x = driven wheels) | | 1X-2/4 |
| Max. lift height | h_2 (mm) | 190/180 |
| Height of tiller in drive position min./max | h_{14} (mm) | 950/1310 |
| Overall length | l_1 (mm) | 1508/1578 |
| Length to face of forks | l_2 (mm) | 358 |
| Overall width | b_1 (mm) | 685 |
| Fork dimensions | s/e/l(mm) | 53/160/1150(1220) |
| Width overall forks | b_2 (mm) | 520/550/685 |
| Ground clearance, center of wheelbase | h_1 (mm) | 32/22 |
| Aisle width for pallets 1000x1200(1200crossways) | A_c (mm) | 1708/1778 |
| Aisle width for pallets 800x1200(1200lengthways) | A_s (mm) | 1758/1778 |
| Turning radius | Wa(mm) | 1320/1389 |
| Travel speed,laden/unladen | Km/h | 5.3/5.8 |
| Lift speed,laden/unladen | mm/s | 35/45 |
| Lowering speed,laden/unladen | mm/s | 80/37 |
| Max.gradeability,laden/unladen | % | 5/15 |
| Battery voltage/nominal capacity | V/Ah | 24/80 |
| Battery dimensions l/w/h | mm | 260/169/215 |
| Battery weight | Kg | 49 |
| Service weight | Kg | 230 |
| Service brake | | electric |
| Sound level at the drive's ear acc.to DIN12053 | dB(A) | 70 |

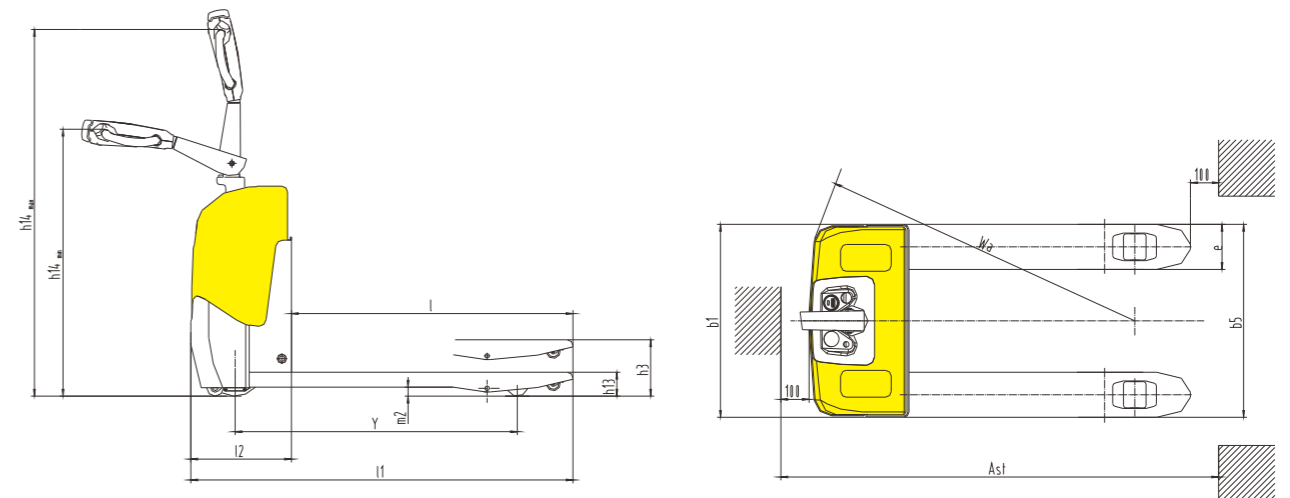

Electric Pallet Truck



Conforms to EN 1175-1:1998
EN ISO3691-1:2008
Based on Directive 2006/42/EC

Model: CBD14



Smart Mover

Advantages:

SAFETY AND PRODUCTIVITY:

- SepEx control system provides smooth acceleration and energy saving braking.
- Emergency reversing device.
- Multi-function display: battery status, hour meter, fault indicator etc.
- Built-in pressure relief valve protects the trucks from overloads.
- Braking applies with handle upright and horizontal position.
- Emergency power disconnect.
- Low speed switch in the handle.
- Stepless speed control.

STRUCTURAL:

- Parallel motor mounting on vertical drive wheel ensures convenience for inspection and maintenance while also ensuring a small turning radius.
- The structure of motor is water-proof and dust-proof, which makes the braking and motor more durable and reliable.
- Built-in charger for easy charging.
- Spring-loaded castors improve lateral stability on uneven floors and enhance truck performance and service life.
- One-piece heavy gauge steel is formed for maximum strength forks.
- Compact and smart structure, with particular small radius, which is a good choice for narrow aisle operation.

SERVICEABILITY:

- Low battery protection setting prolongs the battery use time.
- Combined balance wheels, driving system is steady, preventing the truck being rocked from side to side.
- CANbus technology reduces wiring complexity and increases reliability.
- Hall-effect throttle control eliminates wear components and requires no mechanical adjustment.
- All pivot points have grease fitting and serviceable bushing, reducing component wear and extending component life.
- The back cover is easy to open, convenient to repair and maintain.



MOSFET Control System



Multi-function Display, Built-in Charger



Entry Rollers



Free handle (option)

1KG=2.205LB 1INCH=25.40MM

| MODEL | CBD14 | |
|---|-----------------|---------------------------|
| Drive type | electric | |
| Operation type | pedestrian | |
| Load capacity | Q(kg) | 1400 |
| Load centre distance | c(mm) | 600 |
| Load distance, centre of drive axle to fork | x(mm) | 845/895/965 |
| Fork height, lowered | h_{13} (mm) | 77/83 |
| Wheelbase | y(mm) | 1112/1162/1232 |
| Axle loading, laden front/rear | kg | 575/1085 |
| Axle loading, unladen front/rear | kg | 220/40 |
| Tyres | polyurethane | |
| Tyre size, front | mm | φ 250x60 |
| Tyre size, rear | mm | φ 82(75)x96 / φ 82(75)x62 |
| Additional wheels(dimensions) | mm | φ 100x40 |
| Wheels, number front rear(x=driven wheels) | 1X+2/2 or 4 | |
| Tread, front | b_{10} (mm) | 490 |
| Tread, rear | b_{11} (mm) | 370/400/500 |
| Max. lift height | h_3 (mm) | 197/203 |
| Height of tiller in drive position min./max. | h_{14} (mm) | 850/1240 |
| Overall length | l_1 (mm) | 1540/1590/1647 |
| Length to face of forks | l_2 (mm) | 442 |
| Overall width | b_1 (mm) | 735 |
| Fork dimensions | s/e/l(mm) | 53x150x1100(1150/1207) |
| Width overall forks | b_3 (mm) | 520/550/650 |
| Ground clearance, centre of wheelbase | m_2 (mm) | 25 |
| Aisle width for pallets 1000x1200 crossways | A_{s1} (mm) | 1831/1881/1951 |
| Aisle width for pallets 800x1200 lengthways | A_{s2} (mm) | 1930/1932/1951 |
| Turning radius | W_1 (mm) | 1377/1427/1497 |
| Travel speed, laden/unladen | Km/h | 4.5/5 |
| Lift speed, laden/unladen | m/s | 0.024/0.03 |
| Lowering speed, laden/unladen | m/s | 0.04/0.035 |
| Max.gradeability, laden/unladen | % | 5/10 |
| Service brake | Electromagnetic | |
| Battery voltage, nominal capacity K_0 | V/Ah | 24/80 |
| Battery weight | Kg | 54 |
| Battery dimensions l/w/h | mm | 260x168x210 |
| Sound level at the driver's ear acc. to DIN 12053 | dB(A) | 70 |
| Service weight (with battery) | kg | 260 |

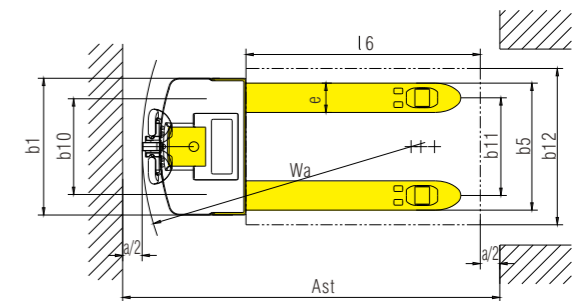
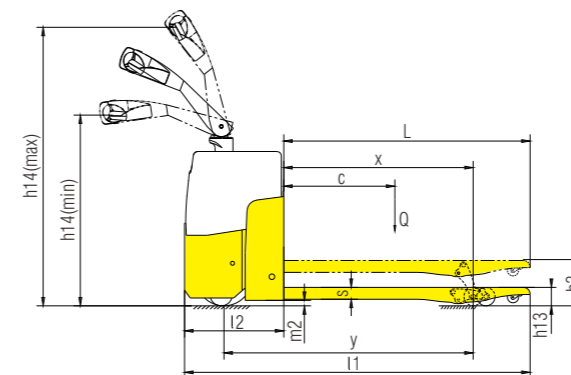



Model: CBD20K(D)

The super light Walkie type CBD20K(D) (2000kg/4400lbs) with small turning radius and low profile chassis, widely used in **Narrow Space** like small super market and workshop.

Advantages:

SAFETY AND PRODUCTIVITY:

- Advanced AC control system eliminating the motor brushes and directional contactors, which makes the minimal maintenance requirements. Intelligent regenerative brake system: increase overall truck performance by decreasing battery charge intervals.
- Side-way battery with roll-out system is very convenient to replace batteries.
- Emergency reversing device.

One set side way battery

AC



Conforms to EN 1175-1:1998
EN ISO3691-1:2008
Based on Directive 2006/42/EC

<https://forklift-manuals.jimdofree.com>



Swing-out battery

- Built-in pressure relief valve protects the trucks from overloads.
- Long handle tube gives flexible and laborsaving operation.
- Emergency power disconnect.
- Low speed switch in the handle.
- Stepless speed control.

STRUCTURAL:

- Vertical driving wheel offers small turning radius. The structure is water-proof and dust-proof.
- The riser axle located at the highest point of forks, which protect riser axles from constant contact from uneven floors. Pull rod design protect the rod from bending.
- Spring-loaded castors improve lateral stability on uneven floors and enhance truck performance and service life.
- One-piece heavy gauge steel is formed for maximum strength forks.

SERVICEABILITY:

- Low battery protection setting prolongs the battery use time.
- CANbus technology reduces wiring complexity and increases reliability.
- All pivot points have grease fitting and serviceable bushing, reducing component wear and extending component life.

1KG=2.205LB 1INCH=25.40MM

| MODEL | | CBD20K(D)-I | CBD20K(D)-II |
|--|--------------------|---------------------------------------|------------------------------|
| battery type | | 1 set side way battery | swing-out battery |
| Drive | | electric | electric |
| Operate type | | walkie | walkie |
| Load capacity/rated load | Q(kg/lbs) | 2000/4400 | 2000/4400 |
| Load centre distance | c(mm/inch) | 600/23.6 | 600/23.6 |
| Load distance,centre of drive axle to fork | x(mm/inch) | 815/865/935(32/34/36.8) | 935/36.8 |
| Fork Height, lowered | h_{13} (mm/inch) | 82/3.2 | 82/3.2 |
| Wheelbase | y(mm/inch) | 1211/1261/1331(47.7/49.6/52.4) | 1361/53.6 |
| Axle loading,laden front/rear | kg/lbs | 1170/1450(2580/3198) | 1170/1450(2580/3198) |
| Axle loading,unladen front/rear | kg/lbs | 470/150(1036/330) | 470/150(1036/330) |
| Tyres | | polyurethane | polyurethane |
| Tyre size,front | mm/inch | ϕ 250x70/ ϕ 10x2.8 | ϕ 250x70/ ϕ 10x2.8 |
| Tyre size rear | mm/inch | ϕ 82x126/ ϕ 3.2x5 | ϕ 82x98/ ϕ 3.2x3.9 |
| Additional wheels(dimensions) | mm/inch | ϕ 127x57/ ϕ 5x2.2 | ϕ 127x57/ ϕ 5x2.2 |
| Wheels,number front rear(x=driven wheels) | | 1X+2/2(4) | 1X+2/2(4) |
| Tread,front | b_{10} (mm/inch) | 510/20 | 510/20 |
| Tread,rear | b_{11} (mm/inch) | 340/370/470/505(13.4/14.6/18.5/19.9) | 470/505(18.5/19.9) |
| Max. lift height | h_2 (mm/inch) | 202/8 | 202/8 |
| Height of tiller in drive position min./max. | h_{12} (mm/inch) | 780/1230(30.7/48.4) | 780/1230(30.7/48.4) |
| Overall length | l_1 (mm/inch) | 1655/1705/1775(65.2/67.1/69.1) | 1805/71 |
| Length to face of forks | l_2 (mm/inch) | 555/21.9 | 555/21.9 |
| Overall width | b_1 (mm/inch) | 775/30.5 | 775/30.5 |
| Fork dimensions | s/e/l(mm/inch) | 54x180x1100/1150/1220(2.1x7x43/45/48) | 54x180x1220/2.1x7x48) |
| Width overall forks | b_2 (mm/inch) | 520/550/650/685(20.5/22/26/27) | 550/685(22/27) |
| Ground clearance,centre of wheelbase | m_2 (mm/inch) | 28/1.1 | 28/1.1 |
| Aisle width for pallets 1000x1200 crossways | A_{10} (mm/inch) | 2015/2065/2135(79/81/84) | 2165/85 |
| Aisle width for pallets 800x1200 lengthways | A_{11} (mm/inch) | 2115/2115/2135(83/83/84) | 2165/85 |
| Turning radius | W_2 (mm/inch) | 1400/1450/1520(55/57/60) | 1550/61 |
| Travel speed,laden/unladen | Km/h | 5.5/5.6 | 5.5/5.6 |
| Lift speed,laden/unladen | m/s | 0.039/0.056 | 0.039/0.056 |
| Lowering speed,laden/unladen | m/s | 0.064/0.050 | 0.064/0.050 |
| Gradeability,laden/unladen | % | 6/12 | 6/12 |
| Max.gradeability,laden/unladen | % | 8/20 | 8/20 |
| Service brake | | Electro magnetic | Electro magnetic |
| Battery voltage,nominal capacity K5 | V/Ah | 24/210 | 24/210 |
| Battery weight | Kg/lbs | 170/375 | 170/375 |
| Battery box dimensions | mm/inch | 750x170x534(30x6.7x21) | ~ |
| Sound level at the driver's ear acc.to DIN 12053 | dB(A) | 70 | 70 |
| Service weight (with battery) | kg/lbs | 620/1367 | 620/1367 |

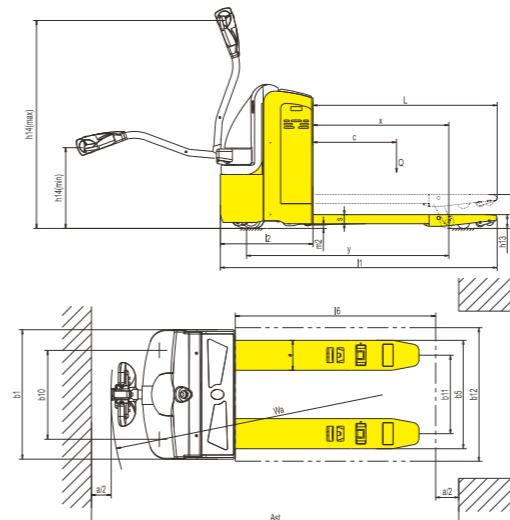

Drive System



Multi function indicator and hour meter



Option: swing-out battery tray



Model: CBD20H

AC Function

<https://forklift-manuals.jimdofree.com>

Advantages:

- Load capacity is 2000kg.
- DC **Brushless motor** drive, which is convenient to control.
- Mechanical steering.
- Service brake is combined regenerative and electro-magnetic system, which allows safe and reliable brake and prolongs the use time.
- Side-way battery with roll out system is very convenient to replace batteries.
- The guide wheel on fork head allows convenient pallet work.
- High efficiency motor keeps long time continuous work and is energy saving and environmental.
- Travel speed under laden arrives at 5KM/H, the maximum gradeability can achieve 6%.
- With nice looking ,not exposed balanced wheel is more safe.
- Vulnerable parts like fork wheel, bearing and cylinder is in common use with CBD20H, which is easy for maintainance.

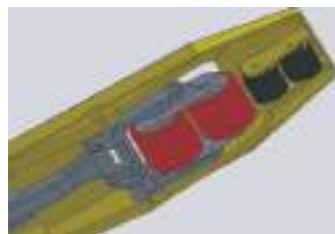

Steel guide wheels are mounted on fork head, which allows convenient pallet work.



1. Side-way battery with roll-out system is convenient to replace and suitable for 2 shifts or more shifts working.
2. New design of overall cover with good looking, and new design of balanced wheel makes it unexposed.



1KG=2.205LB 1INCH=25.40MM

| MODEL | CBD20H | |
|---|--------------------------------|------------------------|
| Drive type | Electric | |
| Operation type | Standing | |
| Load capacity | Q(kg) | 2000 |
| Load center | c(mm) | 600 |
| Load distance | x(mm) | 800/850/920 |
| Wheelbase | Y(mm) | 1200/1250/1320 |
| Service weight (with battery) | kg | 500 |
| Axle loading, laden front/rear | kg | 782/1718 |
| Axle loading, unladen front/rear | kg | 382/118 |
| Tyres | Polyurethane | |
| Tyre size, front | Φ250×80 | |
| Tyre size, rear | Φ80×70 | |
| Additional wheels (dimensions) | Φ114×60 | |
| Wheels, number front rear(x=driven wheels) | 1X+2/4 | |
| Tread, front | b10(mm) | 540 |
| Tread, rear | b11(mm) | 340/370/470/505 |
| Max. Lift height | h3(mm) | 120 |
| Initial lift | h14(mm) | 850/1200 |
| Fork height, lowered | h13(mm) | 85 |
| Overall length | l1(mm) | 1695/1745/1815 |
| Length to face of forks | l2(mm) | 595 |
| Overall width | b1(mm) | 765 |
| Fork dimensions | S/e/l(mm) | 53×180×1100(1150/1220) |
| Width overall forks | b5(mm) | 520/550/650/685 |
| Ground clearance, centre of wheelbase | m2(mm) | 28 |
| Aisle width for pallets 1000x1200 crossways | Ast(mm) | 1895/1945/2015 |
| Aisle width for pallets 800x1200 lengthways | Ast(mm) | 1995/1995/2015 |
| Turning radius | Wa(mm) | 1400/1450/1520 |
| Travel speed, laden/unladen | Km/h | 5/5.1 |
| Lift speed, laden/unladen | m/s | 0.030/0.040 |
| Lowering speed, laden/unladen | m/s | 0.050/0.045 |
| Gradeability, laden/unladen | % | 5/10 |
| Max gradeability, laden/unladen | % | 6/12 |
| Service brake | Regenerative + Electromagnetic | |
| Drive motor capacity | kW | 0.8 |
| Lift motor capacity | kW | 0.8 |
| Battery voltage, nominal capacity K5 | V/Ah | 24/165 (210) |
| Battery weight | Kg | 170 (196) |
| Battery dimensions l/w/h | mm | 750×170×474 (534) |
| Sound level at the driver's ear acc. to DIN 12053 | dB(A) | 70 |

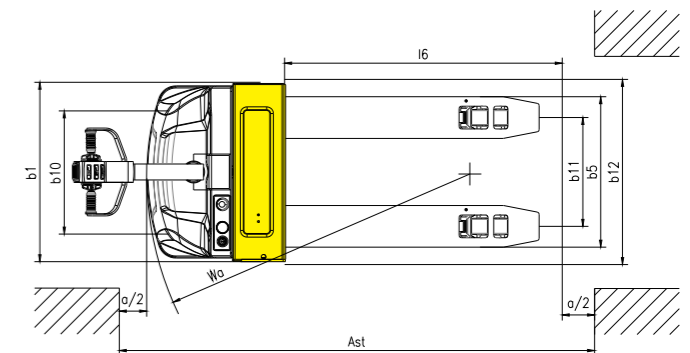
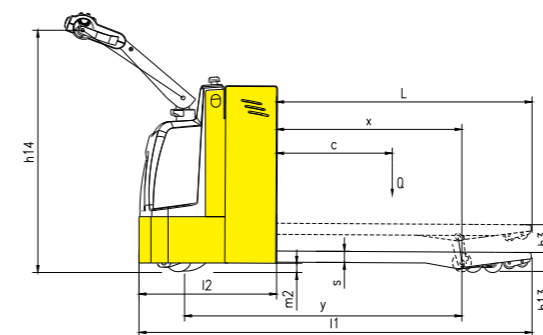



Conforms to EN 1175-1:1998
EN ISO3691-1:2008
Based on Directive 2006/42/EC

Model: CBD20R-I CBD20R-II CBD25R-I

Hot Sale



AC
EPS

Standard features

- Germany FREI Tiller Head
- Emergency stop & belly button
- BDI and hour meter
- Casters to balance stability
- Industrial battery
- Brushless AC motor
- Vertical driving wheel
- Sideway battery change
- Built-in Charger (option)
- Platform with speed sensor

Option

- Fork width and length (size)
- Load backrest
- Out side charger
- Customized battery compartment
- Entry & exist roller for empty pallets
- EPS (for CBD20R-I, CBD25R-I)

The Rider type CBD-R (2000/2500kg) with small turning radius and super light steering system. widely used in **Narrow Space** like small super market and narrow workshop.



MOSFET control system (CBD20R-I)



Foldable platform with speed sensor



Industry battery & locker



Germany Frei tiller head

1KG=2.205LB 1INCH=25.40MM

| MODEL | | CBD20R-I | CBD25R-I | CBD20R-II |
|---|---------------|------------------------|------------------------|-------------------------|
| Drive type | | electric | electric | electric |
| Operation type | | standing | standing | standing |
| Load capacity | Q(kg) | 2000 | 2500 | 2000 |
| Load centre distance | c(mm) | 600 | 600 | 600 |
| Load distance, centre of drive axle to fork | x(mm) | 818/868/938 | 818/868/938 | 815/865/935 |
| Fork height, lowered | h_{13} (mm) | 85/80 | 85/80 | 82 |
| Wheelbase | y(mm) | 1302/1352/1422 | 1302/1352/1422 | 1211/1261/1331 |
| Axle loading, laden front/rear | kg | 1640/1080 | 2040/1180 | 1300/1410 |
| Axle loading, unladen front/rear | kg | 160/560 | 160/560 | 110/600 |
| Tyres | | polyurethane | polyurethane | polyurethane |
| Tyre size, front | mm | φ 250x70 | φ 250x70 | φ 250×70 |
| Tyre size, rear | mm | φ 82x90/ φ 78x90 | φ 82x90/ φ 78x90 | φ 82×98 |
| Additional wheels(dimensions) | mm | φ 127x57 | φ 127x57 | φ 127×57 |
| Wheels, number front rear(x=driven wheels) | | 1X+2/4 | 1X+2/4 | 1X+2/2(4) |
| Tread, front | b_{10} (mm) | 490 | 490 | 490 |
| Tread, rear | b_{11} (mm) | 340/370/470/505 | 340/370/470/505 | 340/370/470/505 |
| Max. lift height | h_3 (mm) | 195/205 | 195/205 | 202 |
| Height of tiller in drive position min./max. | h_{14} (mm) | 1150/1450 | 1150/1450 | 1150/1430 |
| Overall length | l_1 (mm) | 1823/1873/1943 | 1823/1873/1943 | 1710/1760/1830 |
| Length to face of forks | l_2 (mm) | 723 | 723 | 610 |
| Overall width | b_1 (mm) | 733 | 733 | 775 |
| Fork dimensions | s/e/l(mm) | 53x180x1100(1150/1220) | 53x180x1100(1150/1220) | 53×180×1100 (1150/1220) |
| Width overall forks | b_3 (mm) | 520/550/650/685 | 520/550/650/685 | 520/550/650/685 |
| Ground clearance, centre of wheelbase | m_2 (mm) | 30 | 30 | 28 |
| Clearance for pallets 1000x1200 crossways | A_{s1} (mm) | 2135/2185/2255 | 2135/2185/2255 | 1910/1960/2030 |
| Aisle width for pallets 800x1200 lengthways | A_{s2} (mm) | 2235/2235/2255 | 2235/2235/2255 | 2010/2010/2030 |
| Turning radius | W_1 (mm) | 1700/1750/1820 | 1700/1750/1820 | 1550/1600/1670 |
| Travel speed, laden/unladen | Km/h | 7.9/8 | 6.7/6.8 | 7/7.1 |
| Lift speed, laden/unladen | m/s | 0.03/0.032 | 0.03/0.032 | 0.039/0.056 |
| Lowering speed, laden/unladen | m/s | 0.032/0.03 | 0.032/0.03 | 0.064/0.050 |
| Max. gradeability, laden/unladen | % | 10/20 | 8/20 | 8/20 |
| Service brake | | regenerative | regenerative | Electromagnetic brake |
| Battery voltage, nominal capacity K_5 | V/Ah | 24/240 | 24/240 | 24/210 |
| Battery weight | Kg | 240 | 240 | 170 |
| Battery dimensions l/w/h | mm | 650x250x505 | 650x250x505 | 750×170×534 |
| Sound level at the driver's ear acc. to DIN 12053 | dB(A) | 70 | 70 | 70 |
| Service weight (with battery) | kg | 720 | 720 | 710 |

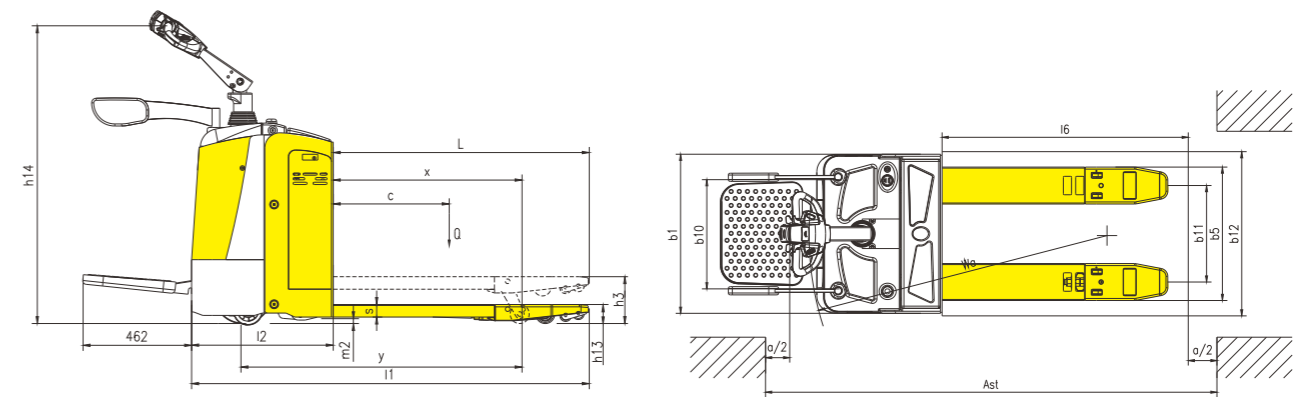



Model: CBD25T CBD30T

Option: Max capacity up to 4000kg/8800lbs

The heavy Duty type CBD-T series Rider Pallet Trucks with big capacity from (2500-4000kg/5500-8800lbs), which widely used in huge super market and large warehouse for long distance transport.

AC

EPS



1. Germany Frei handle.
2. High & Low speed switches.
3. Large storage compartment near console to store tools, pencils and paper.

Advantages:

GOOD SAFETY AND EFFICIENCY

- The truck features a smooth running, strong load capacity and excellent climbing ability, and the truck body and wheels are durable and reliable.
- Side-standing operation and equipped with safety handle bar provide safety operation.
- Power steering system(EPS) ensures effortless and highly efficient maneuver ability.
- Multi-function display: battery status, hour meter, fault code, slow running state, etc.
- Safety armrest equipped with operating switch design allows control of lifting/lowering, slow running and the horn functions with either hands.
- High-capacity Battery (300-750Ah)and high-power Drive Motor provides strong power and ensures lasting runtime.
- The advanced controlling system uses efficient micro computer MOS, drive motor is the AC adjustable-speed motor which provides long life and good speed adjusting performance, and is maintenance-free.
- AC- motor eliminates carbon brushes and has good starting performance of the ramp.
- The handle is equipped with an emergency reverse direction switch, which provides safer operation.
- Build-in pressure relief valve protects the truck from overloads, and increases the truck's reliability.
- Emergency power disconnecter.
- Turtle- shaped low speed switch.

STRUCTURAL:

- Standing drive motor system easy for maintenance.
- Equipped with a load-backrest(different height is available).
- The lifting height reaches 135mm, which provides better passing ability.
- Combined balance wheels increase steadiness, preventing the truck from being rocked from side to side.
- The balance wheel is detachable, it is convenient to maintain.
- The side door of battery is conveniently to be replaced and service .

EASY MAINTENANCE

- Low battery protection setting prolong the battery use time.
- CANbus technology reduces wiring complexity, making the line clear, orderly and easy to repair. And also increases the truck's reliability.
- Hall-effect throttle control eliminates wear components and prolongs its use time.
- With reasonable design, the cover is reliable and easy to dismantle, which makes the maintenance of the electrical parts very easy.

<https://forklift-manuals.jimdofree.com>

1KG=2.205LB 1INCH=25.40MM

| MODEL | | CBD25T | CBD30T |
|--|--|---------------------------|---------------------------|
| Drive | | Electric | Electric |
| Operator type | | standing | standing |
| Load capacity/rated load | Q(kg/lbs) | 2500/5500 | 3000/6600 |
| Load centre distance | c(mm/inch) | 600/24 | 600/24 |
| Load distance,centre of drive axle to fork | x(mm/inch) | 933/36.8 | 933/36.8 |
| Wheelbase | Y(mm/inch) | 1491/58.7 | 1491/58.7 |
| Axle loading,laden front/rear | kg/lbs | 1240/2120(2734/4674) | 1360/2500(2998/5500) |
| Axle loading,unladen front/rear | kg/lbs | 640/220(1410/486) | 640/220(1410/486) |
| Tyres | | polyurethane | polyurethane |
| Tyre size, front | mm/inch | φ 250x80/ φ 10x3.2 | φ 250x80/ φ 10x3.2 |
| Tyre size, rear | mm/inch | φ 82x173/ φ 3.2x6.8 | φ 82x173/ φ 3.2x6.8 |
| Additional wheels(dimensions) | mm/inch | φ 127x57/ φ 5x2.3 | φ 127x57/ φ 5x2.3 |
| Wheels, number front rear(x=driven wheels) | | 1X+2/2 | 1X+2/2 |
| Tread, front | b ₁₀ (mm/inch) | 691/27.2 | 691/27.2 |
| Tread, rear | b ₁₁ (mm/inch) | 455/17.9 | 455/17.9 |
| Max. lift height | h ₃ (mm/inch) | 217/8.5 | 217/8.5 |
| Height of tiller in drive position min./max. | h ₁₄ (mm/inch) | 1041/1374(41/54.1) | 1041/1374(41/54.1) |
| Height,lowered | h ₁₃ (mm/inch) | 82/3.2 | 82/3.2 |
| Overall length | l ₁ (mm/inch) | 2143/84.4 | 2143/84.4 |
| Length to face of forks | l ₂ (mm/inch) | 923/36.3 | 923/36.3 |
| Overall width | b ₁ /b ₂ (mm/inch) | 936/36.9 | 936/36.9 |
| Fork dimensions | s/e/l(mm/inch) | 55x230x1220/2.2x9.1x48 | 55x230x1220/2.2x9.1x48 |
| Width overall forks | b ₂ (mm/inch) | 685/27 | 685/27 |
| Ground clearance,centre of wheelbase | m ₂ (mm/inch) | 27/1.1 | 27/1.1 |
| Width for pallets 1000x1200 crossways | A ₁ (mm/inch) | 2343/92.2 | 2343/92.2 |
| Aisle width for pallets 800x1200 lengthways | A ₂ (mm/inch) | 2343/92.2 | 2343/92.2 |
| Turning radius | W ₃ (mm/inch) | 1860/73.2 | 1860/73.2 |
| Travel speed,laden/unladen | Km/h | 7.5/8 | 6/6.5 |
| Lift speed,laden/unladen | m/s | 0.03/0.04 | 0.03/0.04 |
| Lowering speed,laden/unladen | m/s | 0.05/0.045 | 0.05/0.045 |
| Gradeability,laden/unladen | % | 6/8 | 6/8 |
| Max.gradeability,laden/unladen | % | 8/20 | 8/20 |
| Service brake | | regenerative | regenerative |
| Battery voltage,nominal capacity K ₃ | V/Ah | 24/300 | 24/300 |
| Battery weight | kg/lbs | 300/660 | 300/660 |
| Battery dimensions l/w/h | mm/inch | 810x212x665/31.9x8.3x26.2 | 810x212x665/31.9x8.3x26.2 |
| Sound level at the driver's ear acc.to DIN 12053 | dB(A) | 70 | 70 |
| Service weight (with battery) | kg/lbs | 860/1896 | 860/1896 |

Max.Fork length: 2100mm/82inch
Two pallet available

